

| REVISIONS | | | | |
|-----------|-----------------|----------|------------|-------------|
| LTR | DESCRIPTION | DATE | REVISED BY | APPROVED |
| A | INITIAL RELEASE | 11/17/05 | R. NAGY | J. BECHTOLD |

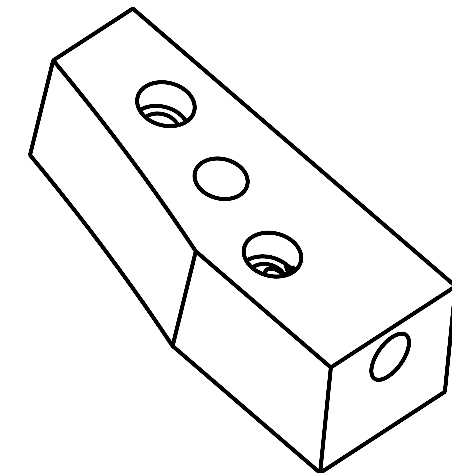

ISO

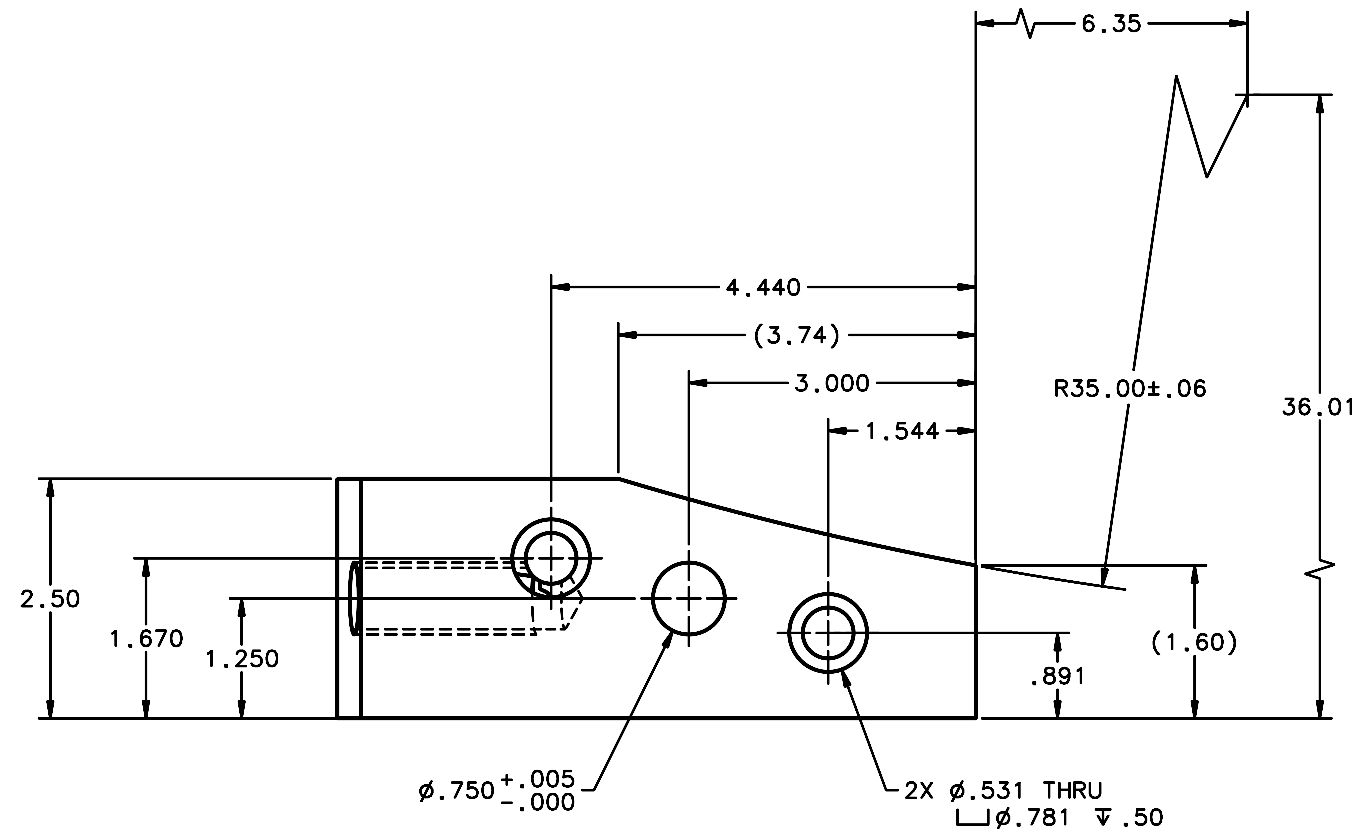
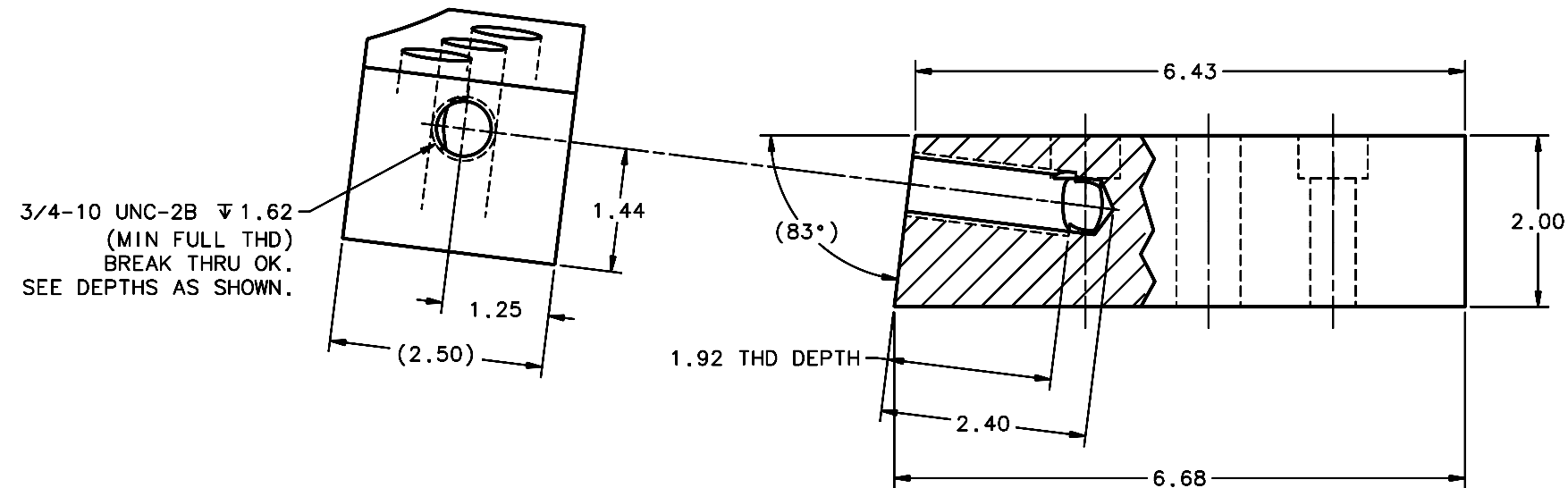

SCALE 1:1

NOTES:

- BREAK SHARP EDGES & DEBURR.
- MACHINED SURFACE FINISH TO BE 125 RMS OR BETTER.
- MACHINED FILLETS TO BE R.015 MAX.
- ANODIZE PER MIL-A-8625, TYPE II, CLASS 2, BLACK.
- DIMENSIONS ARE BEFORE ANODIZE.
- QTY REQD: 1.

OPPOSITE HAND OF 16085

| | | | | | |
|---|---------|---|--------------------------|--|--|
| DO NOT SCALE DRAWING | | THIS DRAWING CREATED IN: | | Steward Observatory, University of Arizona | |
| INTERPRET DIMENSIONS AND TOLERANCES IN ACCORDANCE WITH ASME Y14.5M-94 | | ACAD | MECH | IDEAS | 933 N. Cherry Avenue, Tucson, AZ 85721 (520)621-7659 |
| TOLERANCES UNLESS OTHERWISE SPECIFIED | | <input type="checkbox"/> | <input type="checkbox"/> | <input checked="" type="checkbox"/> | DESIGNED BY: D. DEAN |
| LINEAR | ANGULAR | | | | DATE: 06/15/05 |
| .X | ± .02 | | | | CATEGORY: MMT |
| .XX | ± .02 | | | | DRAWN BY: D. DEAN |
| .XXX | ± .008 | | | | DATE: 10/17/05 |
| DIAMETRICAL SEE SPEC S-002 | | | | | CHECKED BY: R. NAGY |
| DIMENSIONS ARE IN INCHES / DIMENSIONS IN 1/4 ARE METRIC | | | | | DATE: 11/14/05 |
| MATERIAL | | | | | APPROVED BY: J. BECHTOLD |
| 6061-T6 Al | | 16070 | MMT-MAESTRO | | DATE: 11/17/05 |
| FINISH | | NEXT ASSY | USED ON | | APPROVED: |
| 4 | | | | | |
| ASSEMBLY APPLICATION | | CURRENT TIME/DATE/FILE LOCATION: | | DRAWING NUMBER: 16086 | |
| | | DRAWING ARCHIVE LOCATION: http://dovinci.as.arizona.edu/ccad/default.html | | REVISION: A | |