

REVISIONS				
LTR	DESCRIPTION	DATE	REVISED BY	APPROVED
A	INITIAL RELEASE	10/19/05	R. NAGY	J. BECHTOLD

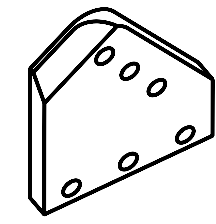
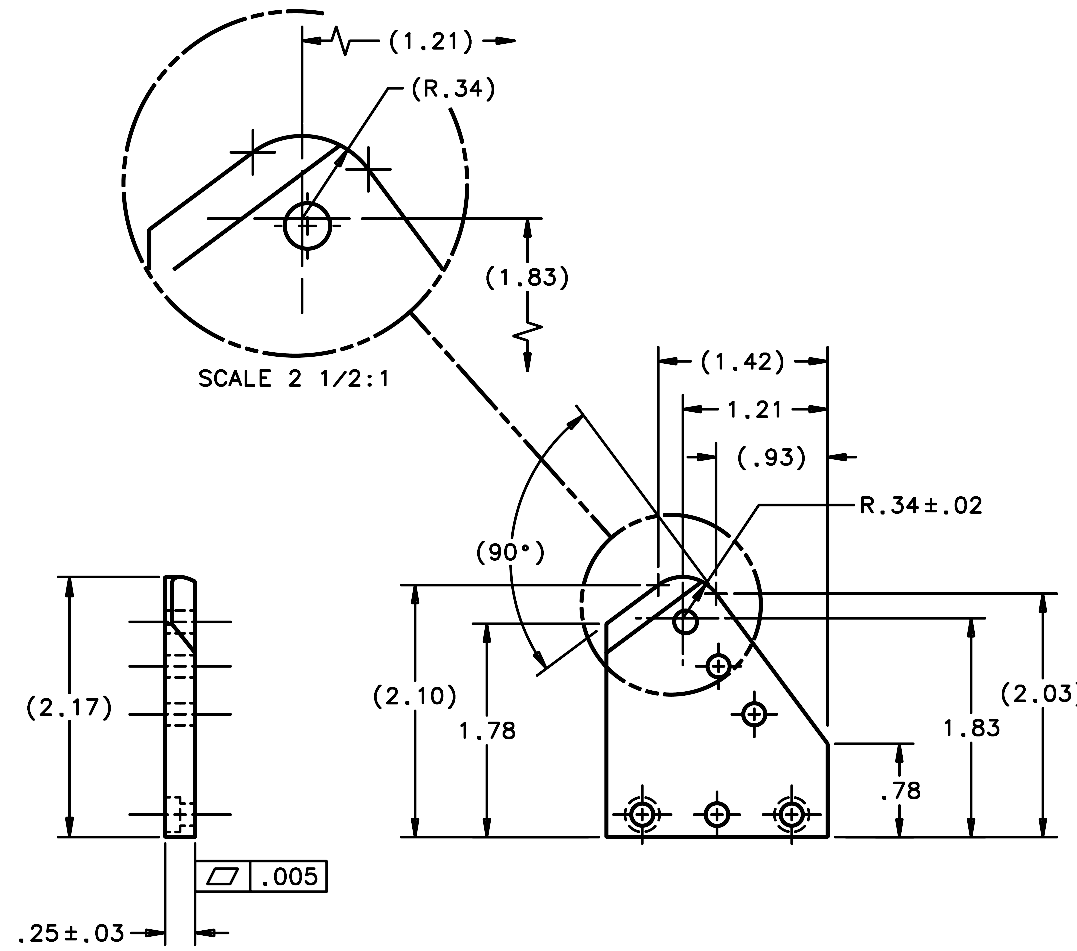
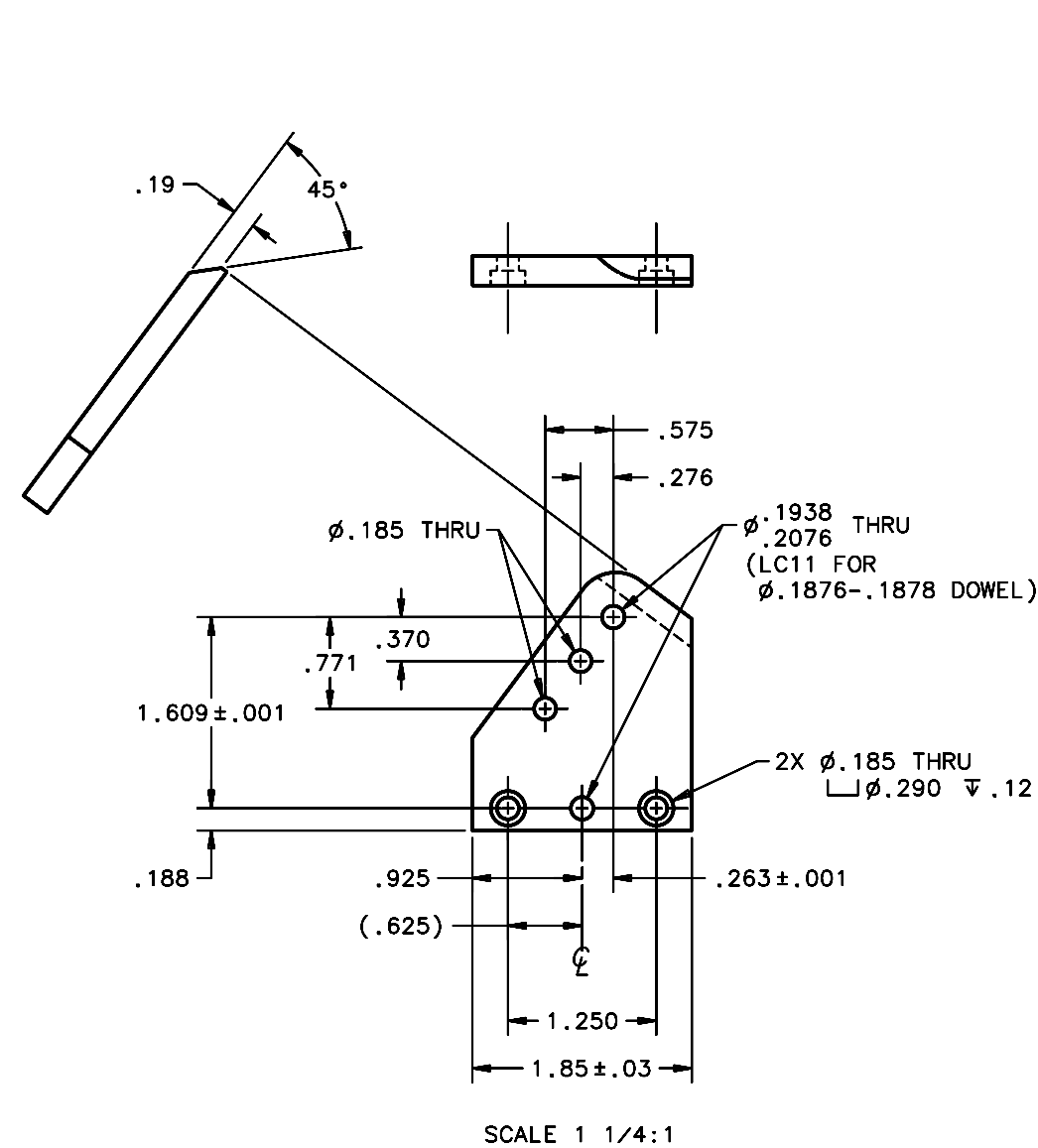

SCALE NTS

NOTES:

- BREAK SHARP EDGES & DEBURR.
- MACHINED SURFACE FINISH TO BE 125 RMS OR BETTER.
- MACHINED FILLETS TO BE .015 MAX.
- ANODIZE PER MIL-A-8625, TYPE II, CLASS 2, BLACK.
- DIMENSIONS ARE BEFORE ANODIZING.
- QTY REQD: 8.

OPPOSITE HAND OF 13240

DO NOT SCALE DRAWING INTERPRET DIMENSIONS AND TOLERANCES IN ACCORDANCE WITH ASME Y14.5M-94		THIS DRAWING CREATED IN: ACAD <input type="checkbox"/> MECH <input type="checkbox"/> IDEAS <input checked="" type="checkbox"/>		Steward Observatory, University of Arizona 933 N. Cherry Avenue, Tucson, AZ 85721 (520)621-7659	
TOLERANCES UNLESS OTHERWISE SPECIFIED LINEAR .X = NA ± .01 .XX = ± .005 ANGULAR ± 1° DIAMETRICAL SEE SPEC S-002		DESIGNED BY: D. DEAN DATE: 9/3/03		CATEGORY: MMT	
MATERIAL 6061-T6 A1		DRAWN BY: R. NAGY 7/19/05		PROJECT: MAESTRO	
FINISH 4		CHECKED BY: J. BECHTOLD 10/19/05		TITLE: TRUSS SPACE FRAME DIAGONAL BRACE "L" END FITTING PLATE	
ASSEMBLY APPLICATION		APPROVED: R. WARNER 10/19/05		PLOT SIZE SCALE: D -	
		APPROVED:		DRAWING NUMBER: 13238	
		CURRENT TIME/DATE/FILE LOCATION:		REVISION: A	
		DRAWING ARCHIVE LOCATION: http://dovinc1.as.arizona.edu/ocod/default.html		SHEET 1 OF 1	