

REVISIONS

LTR	DESCRIPTION	DATE	REVISED BY	APPROVED
A	INITIAL RELEASE	8/2/04	R. NAGY	B. CUERDEN
B	REVISED ITEM 2 GAP TO AGREE WITH FLAT PATTERN	9/14/04	R. NAGY	S. MATHEWS

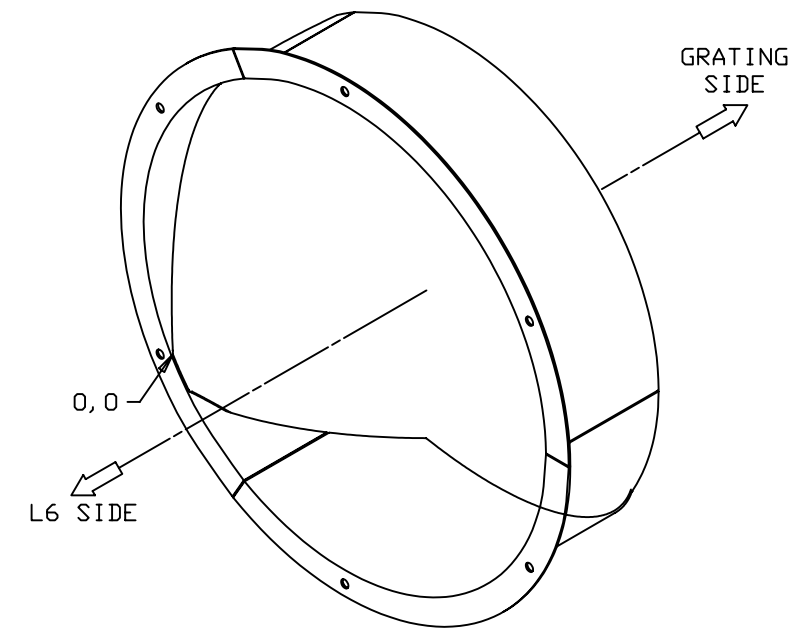
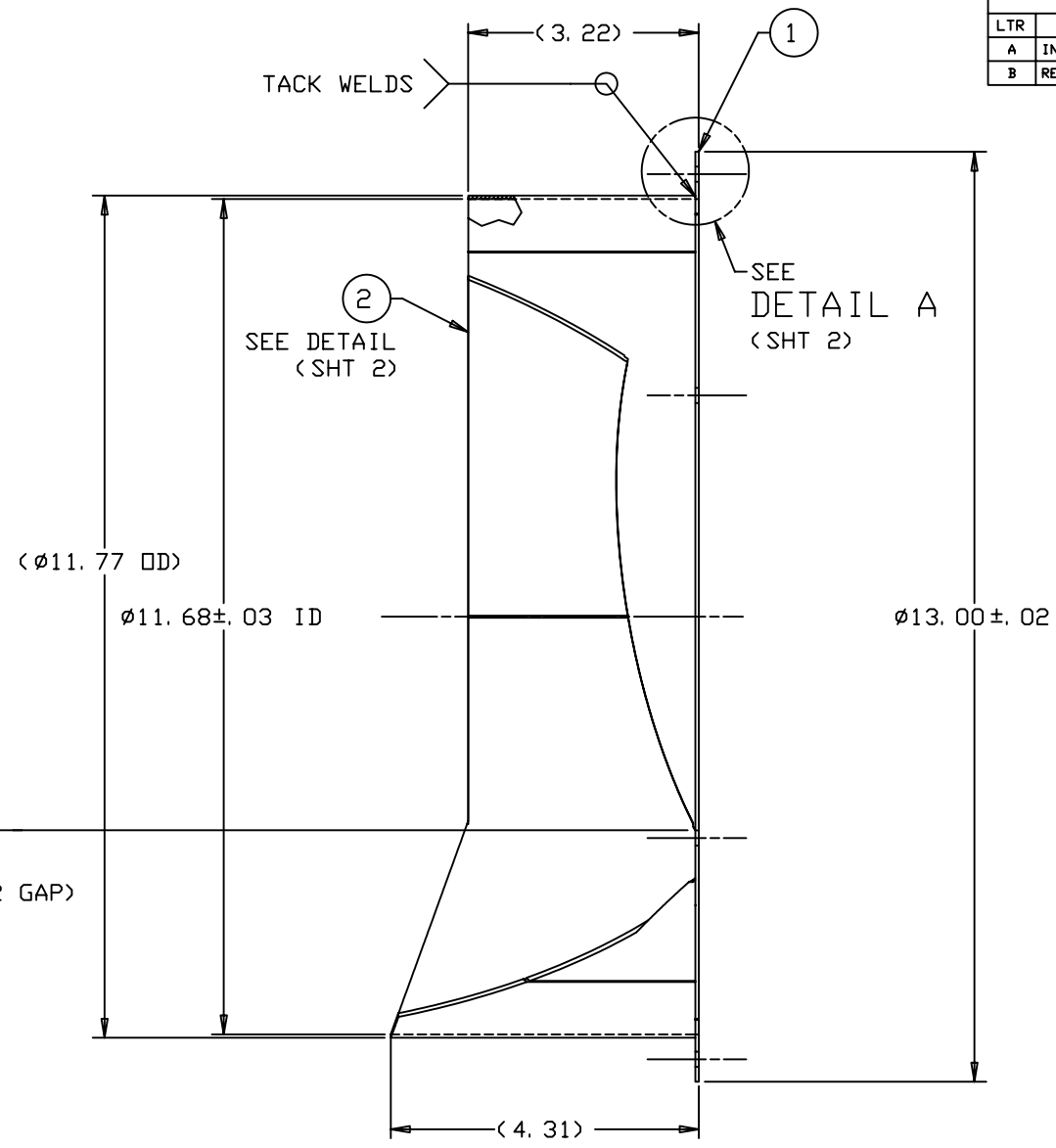
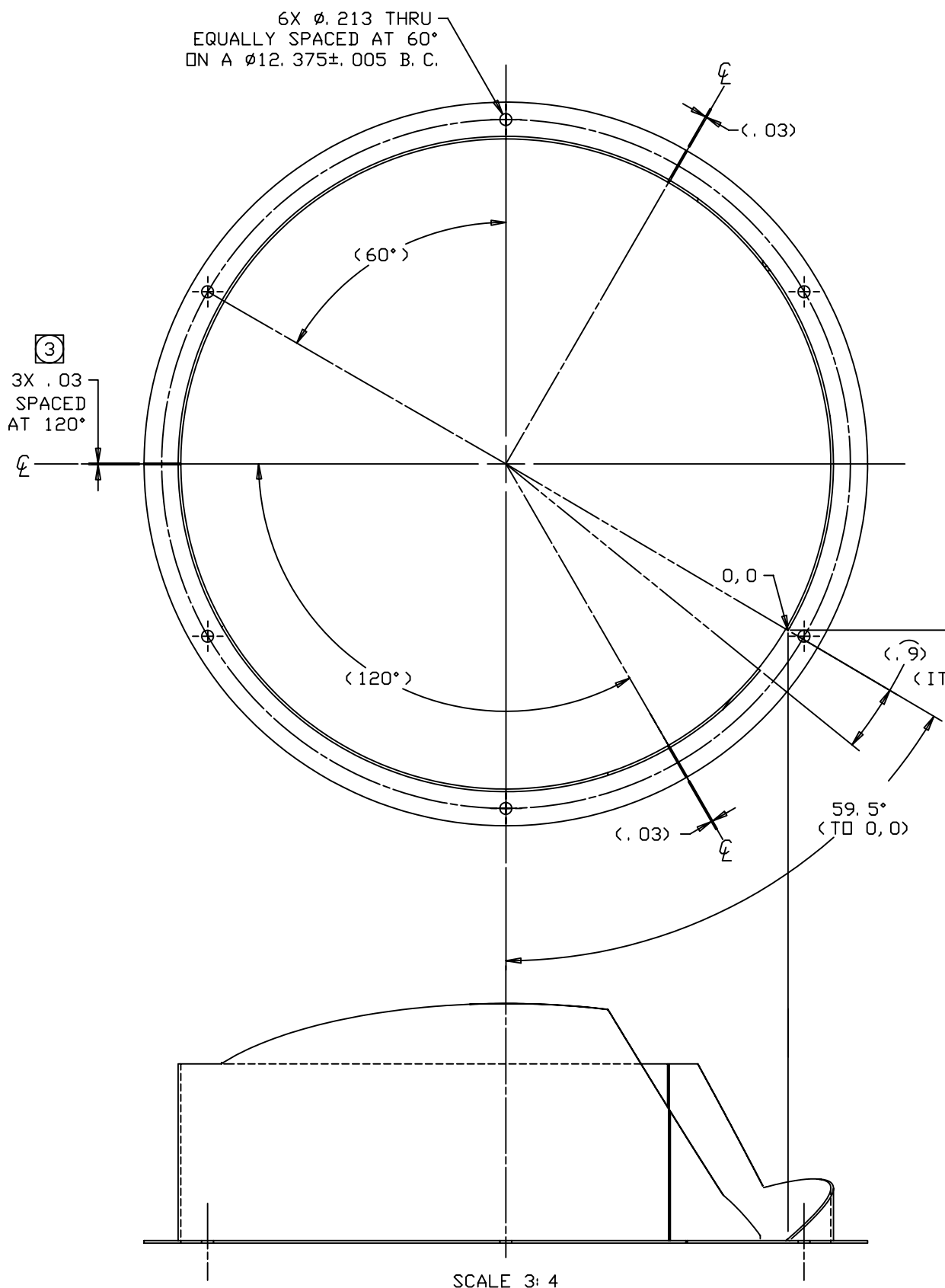

- NOTES:
- BREAK SHARP EDGES & DEBURR.
 - MACHINED SURFACE FINISH TO BE 125 RMS OR BETTER.
 - SAW CUT INTO 3-PIECES AS SHOWN.
 - ZINC CHROMATE EACH PIECE PER ASTM-B-633-98, TYPE II, BLACK.
 - DIMENSIONS ARE BEFORE ZINC CHROMATE.

QTY PER ASSY	-3	-2	-1	PART NUMBER	PART DESCRIPTION	MANUFACTURER or MAT'L SPEC	ITEM NO.
	1	-2			COVER RING		2
	1	-1			BASE RING		1

LIST OF MATERIALS

DO NOT SCALE DRAWING		THIS DRAWING CREATED IN:		Steward Observatory, University of Arizona 933 N. Cherry Avenue, Tucson, AZ 85721 (520)621-7659			
INTERPRET DIMENSIONS AND TOLERANCES IN ACCORDANCE WITH ASME Y14.5M-94		ACAD	MECH	IDEAS	DESIGNED BY: B. CUERDEN/D. DEAN	DATE: 3/10/04	CATEGORY: MMT
TOLERANCES UNLESS OTHERWISE SPECIFIED LINEAR .X = NA .XX = \pm .02 .XXX = NA ANGULAR 2.0° DIAMETRICAL SEE SPEC S-002		<input type="checkbox"/>	<input type="checkbox"/>	<input checked="" type="checkbox"/>	DRAWN BY: R. NAGY	3/11/04	PROJECT: MAESTRO
DIMENSIONS ARE IN INCHES / DIMENSIONS IN [] ARE METRIC					CHECKED BY: G. LANDIS	7/26/04	TITLE: PRISM CELL PRISM FRONT BAFFLE
MATERIAL 1008 STEEL, 18 GA (.0478)					APPROVED: B. CUERDEN	8/2/04	
FINISH 4		13285	MMT		APPROVED: M. REED	8/2/04	
ASSEMBLY APPLICATION		NEXT ASSY	USED ON		APPROVED: J. BECHTOLD	8/2/04	
CURRENT TIME/DATE/FILE LOCATION:		PLOT SIZE SCALE:		DRAWING NUMBER:		REVISION:	
DRAWING ARCHIVE LOCATION: http://dsvinc1.as.arizona.edu/acad/default.html		D -		13286		B	
							SHEET 1 OF 2