

REVISIONS				
LTR	DESCRIPTION	DATE	REVISED BY	APPROVED
A	INITIAL RELEASE	6/13/05	R. NAGY	W. DAVISON

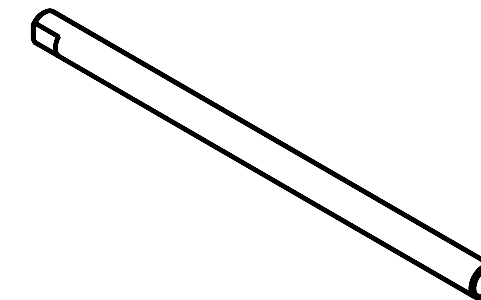
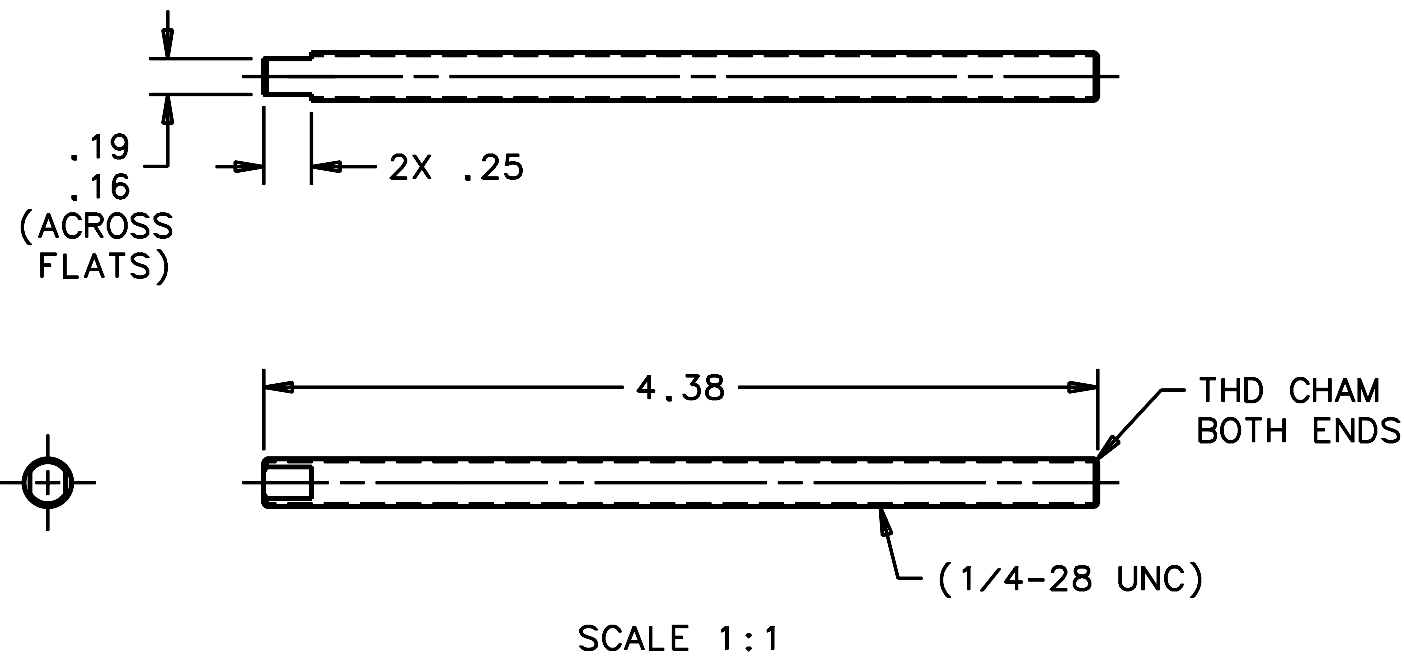

SCALE NTS

NOTES:

1. BREAK SHARP EDGES.
2. MACHINED SURFACE FINISH TO BE 125 RMS OR BETTER.
3. MACHINED FILLETS TO BE R.015 MAX.
4. QTY REQUIRED: 1

DO NOT SCALE DRAWING INTERPRET DIMENSIONS AND TOLERANCES IN ACCORDANCE WITH ASME Y14.5M-94		THIS DRAWING CREATED IN: ACAD <input type="checkbox"/> MECH <input type="checkbox"/> IDEAS <input checked="" type="checkbox"/>		Steward Observatory, University of Arizona 933 N. Cherry Avenue, Tucson, AZ 85721 (520)621-7659			
TOLERANCES UNLESS OTHERWISE SPECIFIED LINEAR .X - .XX .XXX - .XX ANGULAR ±1°				DESIGNED BY: D. DEAN/R. NAGY	DATE: 5/12/05	CATEGORY: MMT	
DIAMETRICAL SEE SPEC S-002				DRAWN BY: R. NAGY	5/16/05	PROJECT: MAESTRO	
MATERIAL THREADED ROD, 1/4-28 UNC, 18-8 SS		13432 MMT-MAESTRO		CHECKED BY: J. BRENNAN	6/8/05	TITLE: LENS CAN SUPPORT-LENS 1 STAGE FOCUS MOTOR TO DRIVE PLATE ROD	
FINISH NONE		NEXT ASSY USED ON		APPROVED: J. BECHTOLD	6/13/05	PLOT SIZE SCALE: DRAWING NUMBER: REVISION: B - 14846 A	
		ASSEMBLY APPLICATION		APPROVED: R. WARNER	6/13/05	CURRENT TIME/DATE/FILE LOCATION: DRAWING ARCHIVE LOCATION: http://devinci.cs.arizona.edu/ocod/default.html	
							SHEET 1 OF 1