

REVISIONS				
LTR	DESCRIPTION	DATE	REVISED BY	APPROVED
A	INITIAL RELEASE	3/10/06	R. NAGY	J. BECHTOLD
B	DRAWING LOG BOOK NUMBERING ERROR; WAS 16156	4/15/06	R. NAGY	R. WARNER

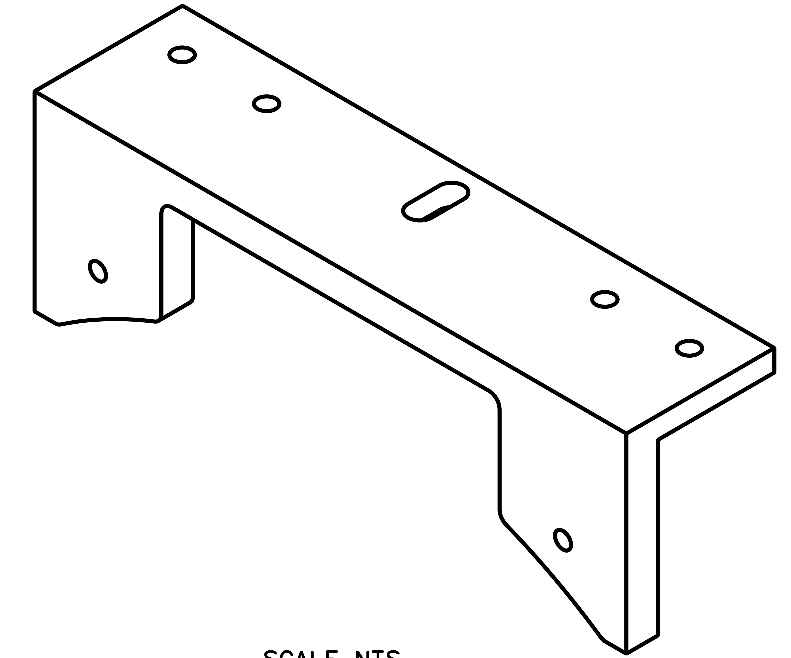
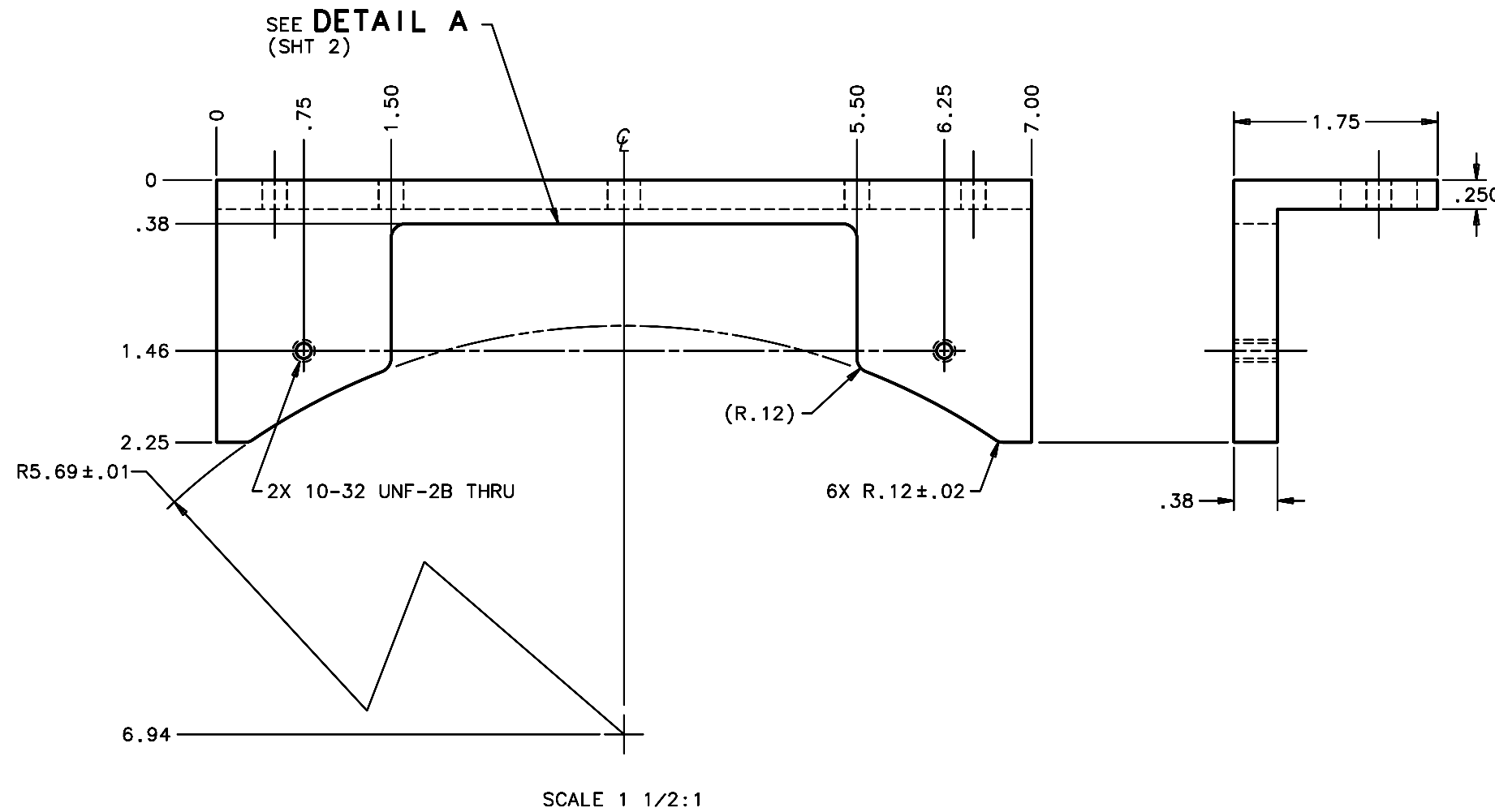
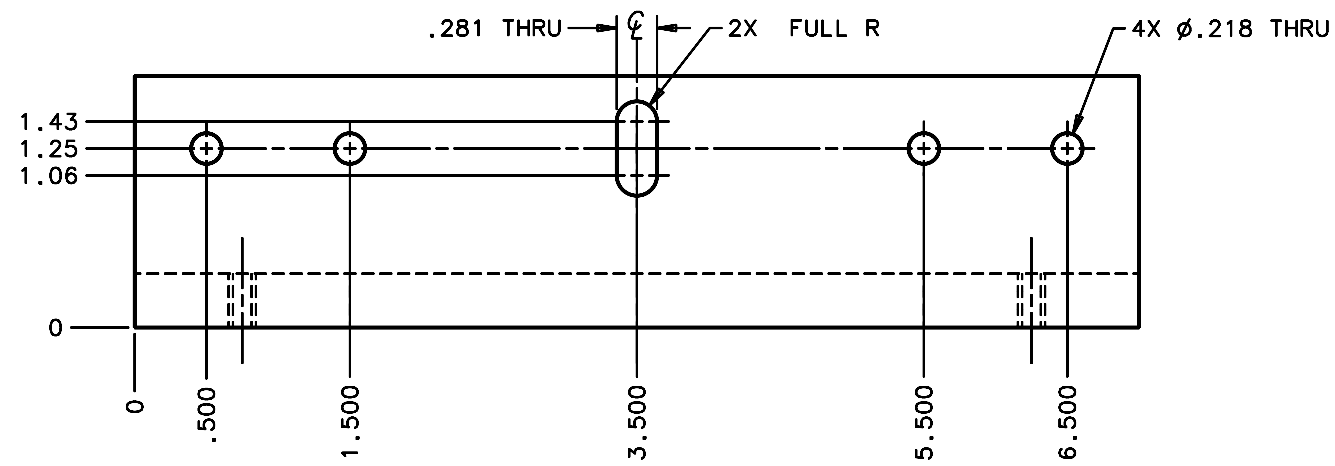

NOTES:

- ① FABRICATE TO SIZE & SHAPE SHOWN USING:
 - A. BAR STOCK -OR-
 - B. STRUCTURAL STEEL ANGLE.
2. BREAK SHARP EDGES & DEBURR.
3. MACHINED SURFACE FINISH TO BE 125 RMS OR BETTER.
4. MACHINED FILLETS TO BE R.03 MAX.
- ⑤ ZINC CHROMATE PER ASTM-B-633-98, TYPE II, GOLD.
6. DIMENSIONS ARE PRIOR TO ZINC CHROMATE.
7. QTY REQD: 3.

DO NOT SCALE DRAWING		THIS DRAWING CREATED IN:			Steward Observatory, University of Arizona				
INTERPRET DIMENSIONS AND TOLERANCES IN ACCORDANCE WITH ASME Y14.5M-94		ACAD	MECH	IDEAS	933 N. Cherry Avenue, Tucson, AZ 85721 (520)621-7659				
TOLERANCES UNLESS OTHERWISE SPECIFIED		<input type="checkbox"/>	<input type="checkbox"/>	<input checked="" type="checkbox"/>	DESIGNED BY:	DATE:	CATEGORY:		
LINEAR					D. DEAN	11/3/05	MMT		
ANGULAR					DRAWN BY:				
.1					R. NAGY	1/17/06		PROJECT: MAESTRO	
.XX					CHECKED BY:				
.XXX					W. DAVISON	3/10/06		TITLE: LEMS CAN SUPPORT LENS CAN 2 SIDE ADJUSTMENT BRACKET	
DIAMETRICAL					APPROVED:				
SEE SPEC S-002					J. BECHTOLD	3/10/06			
MATERIAL					APPROVED:				
1006/1018 STL ①		13424	MMT-MAESTRO		APPROVED:				
FINISH ⑤		NEXT ASSY	USED ON		APPROVED:				
ASSEMBLY APPLICATION					CURRENT TIME/DATE/FILE LOCATION:				
					DRAWING ARCHIVE LOCATION: http://davincl.as.arizona.edu/ccad/default.html				
							PLOT SIZE SCALE:	DRAWING NUMBER:	REVISION:
							D -	17079	B
									SHEET 1 OF 2