

REVISIONS				
LTR	DESCRIPTION	DATE	REVISED BY	APPROVED
A	INITIAL RELEASE	3/10/06	R. NAGY	J. BECHTOLD

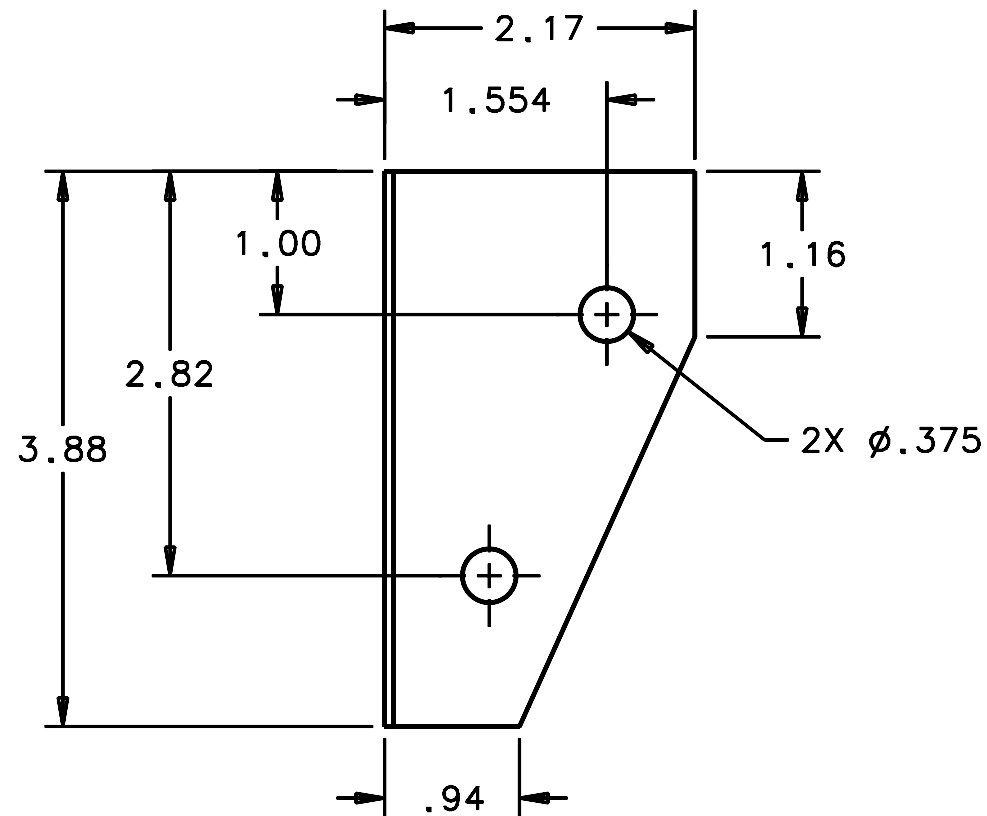

SCALE 3:4

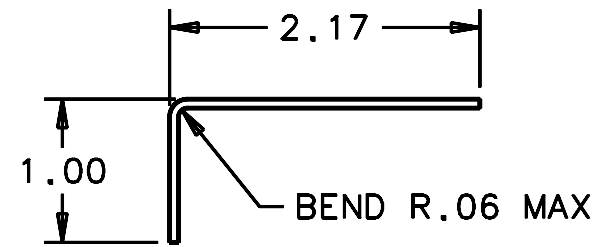
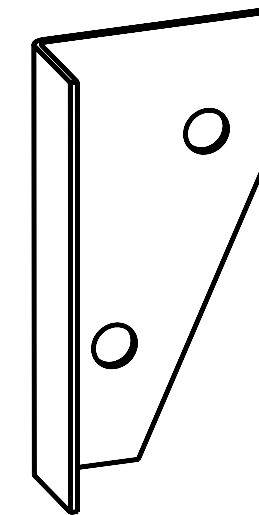

SCALE NTS

OPPOSITE HAND OF 16179

NOTES:

1. BREAK SHARP EDGES & DEBURR.
2. ZINC CHROMATE PER ASTM-B-633-98, TYPE II, GOLD.
3. DIMENSIONS ARE PRIOR TO ZINC CHROMATE.
4. QTY REQD: 12.

DO NOT SCALE DRAWING INTERPRET DIMENSIONS AND TOLERANCES IN ACCORDANCE WITH ASME Y14.5M-94		THIS DRAWING CREATED IN: ACAD <input type="checkbox"/> MECH <input type="checkbox"/> IDEAS <input checked="" type="checkbox"/>		Steward Observatory, University of Arizona 933 N. Cherry Avenue, Tucson, AZ 85721 (520)621-7659			
TOLERANCES UNLESS OTHERWISE SPECIFIED LINEAR .X - .XX .XXX - .03 .010 ANGULAR ±1° DIAMETRICAL SEE SPEC S-002		14858	MMT-MAESTRO	DESIGNED BY: D. DEAN	DATE: 2/20/06	CATEGORY: MMT	
MATERIAL 1006/1018 STL, 16 GA (.0598)		14855	MMT-MAESTRO	DRAWN BY: R. NAGY	3/2/06	PROJECT: MAESTRO	
FINISH 2		14852	MMT-MAESTRO	CHECKED BY: W. DAVISON	3/10/06	TITLE: LENS CAN SUPPORT TEE END LH SIDE BRACKET	
ASSEMBLY APPLICATION		NEXT ASSY	USED ON	APPROVED: J. BECHTOLD	3/10/06	DRAWING NUMBER: 16178	
CURRENT TIME/DATE/FILE LOCATION:				PLOT SIZE		SCALE:	REVISION: A
DRAWING ARCHIVE LOCATION: http://devinci.cs.arizona.edu/ocod/default.html				B -		SHEET 1 OF 1	