

REVISIONS				
LTR	DESCRIPTION	DATE	REVISED BY	APPROVED
A	INITIAL RELEASE	3/7/06	R. NAGY	J. BECHTOLD

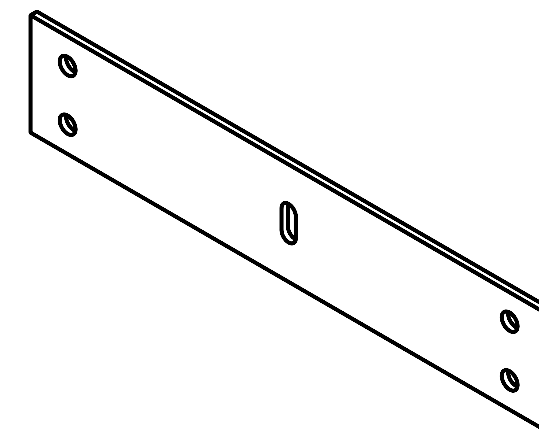
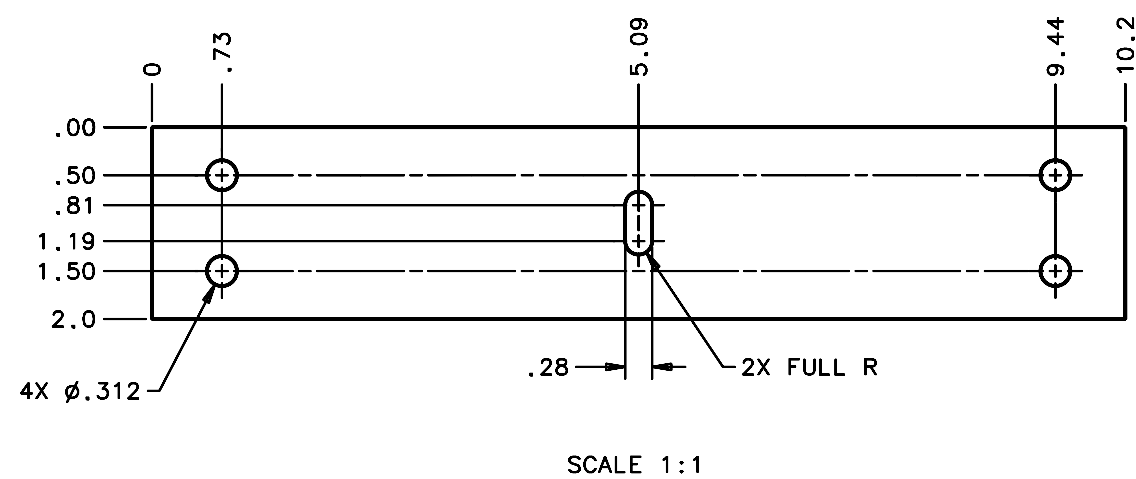

NOTES:

1. BREAK SHARP EDGES & DEBURR.
2. MACHINED SURFACE FINISH TO BE 125 RMS OR BETTER.
3. ZINC CHROMATE PER ASTM-B-633-98, TYPE II, GOLD.
4. DIMENSIONS ARE PRIOR TO ZINC CHROMATE.
5. QTY REQD: 3.

DO NOT SCALE DRAWING INTERPRET DIMENSIONS AND TOLERANCES IN ACCORDANCE WITH ASME Y14.5M-94		THIS DRAWING CREATED IN: ACAD <input type="checkbox"/> MECH <input type="checkbox"/> IDEAS <input checked="" type="checkbox"/>		Steward Observatory, University of Arizona 933 N. Cherry Avenue, Tucson, AZ 85721 (520)621-7659		
TOLERANCES UNLESS OTHERWISE SPECIFIED LINEAR .I = .03 .XX = .01 .XXX = NA ANGULAR .1° DIAMETRICAL SEE SPEC S-002		DESIGNED BY: D. DEAN		DATE: 1/20/06		CATEGORY: MMT
MATERIAL 1006/1018 STL, 11 GA (.1196)		DRAWN BY: R. NAGY		DATE: 1/20/06		PROJECT: MAESTRO
FINISH 3		CHECKED BY: W. DAVISON		DATE: 2/28/06		TITLE: LENS CAN SUPPORT LENS CAN 1 MOUNT
ASSEMBLY APPLICATION		APPROVED: J. BECHTOLD		DATE: 3/7/06		DRAWING NUMBER: 16163
CURRENT TIME/DATE/FILE LOCATION:		NEXT ASSY		USED ON		REVISION: A
DRAWING ARCHIVE LOCATION: <a href="http://dovinci.as.arizona.edu/ccad/default.html">http://dovinci.as.arizona.edu/ccad/default.html</a>		13424		MMT-MAESTRO		PLOT SIZE SCALE: D -
SHEET 1 OF 1						