

REVISIONS				
LTR	DESCRIPTION	DATE	REVISED BY	APPROVED
A	INITIAL RELEASE	11/17/05	R. NAGY	J. BECHTOLD

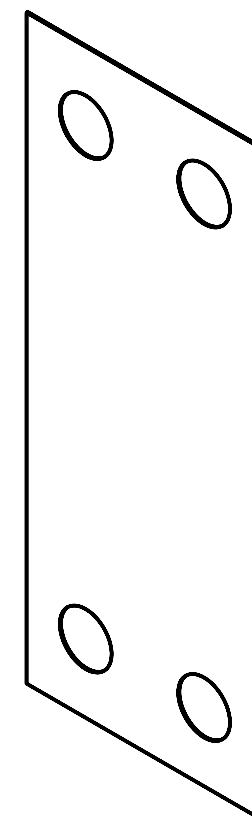
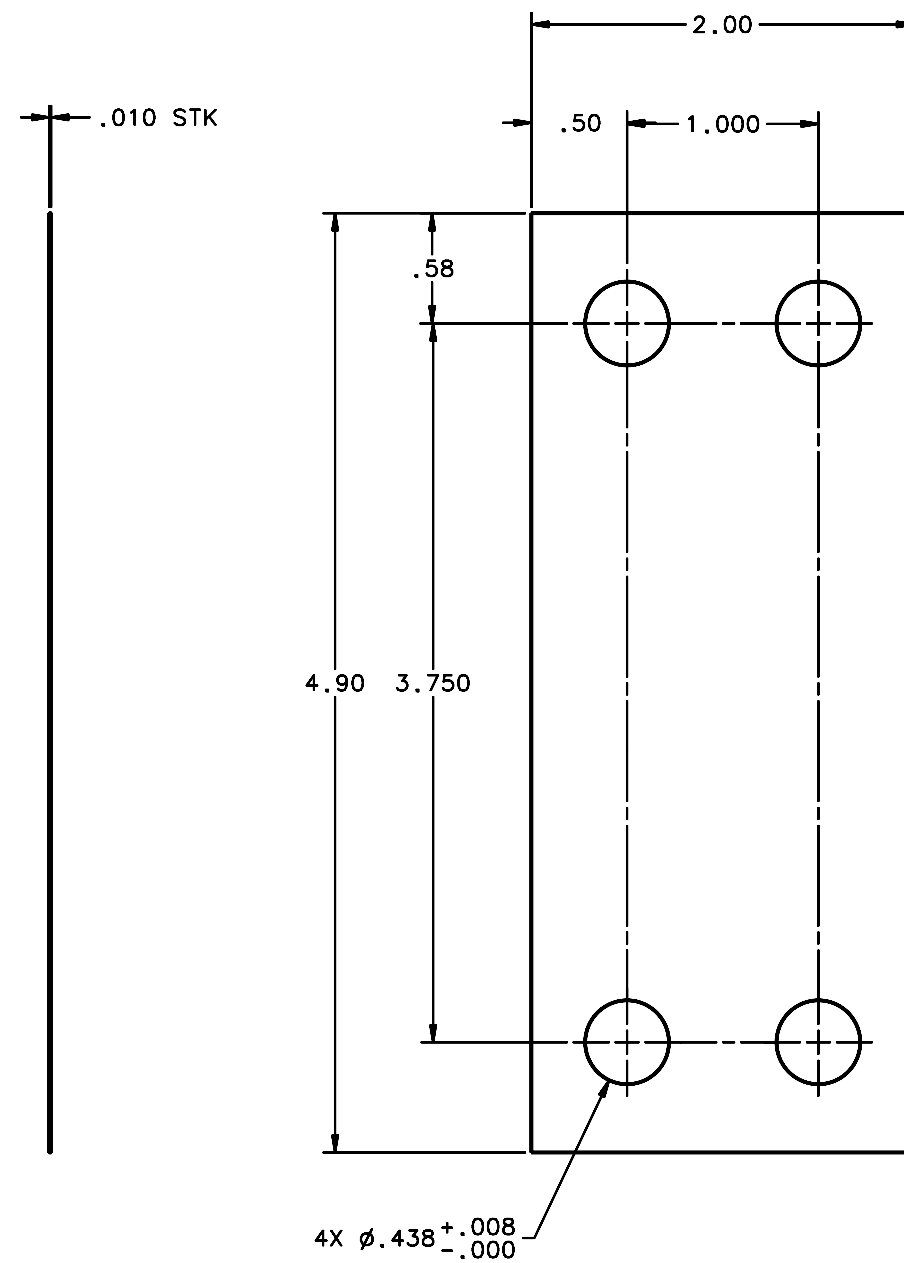

NOTES:

1. BREAK SHARP EDGES & DEBURR.
2. FABRICATE IN STACKS OF 5 PER EACH ASSEMBLY AND BUNDLE TOGETHER FOR 10 MATCHED ASSEMBLY SETS.
3. QTY REQD: 50 (5 PER ASSEMBLY x 10 ASSEMBLIES).

DO NOT SCALE DRAWING		THIS DRAWING CREATED IN:		Steward Observatory, University of Arizona 933 N. Cherry Avenue, Tucson, AZ 85721 (520)621-7659			
INTERPRET DIMENSIONS AND TOLERANCES IN ACCORDANCE WITH ASME Y14.5M-94		ACAD <input type="checkbox"/>	MECH <input type="checkbox"/>	IDEAS <input checked="" type="checkbox"/>	DESIGNED BY: D. DEAN	DATE: 03/19/05	CATEGORY: MMT
TOLERANCES UNLESS OTHERWISE SPECIFIED LINEAR ANGULAR .1 = .004 ±1° .2 = .005 .3 = .006 DIAMETRICAL SEE SPEC S-002					DRAWN BY: D. DEAN	10/04/05	PROJECT: MAESTRO
MATERIAL NYLON 6/6		16060	MMT-MAESTRO		CHECKED BY: R. NAGY	11/14/05	TITLE: TRUSS SPACE FRAME TO WELDMENT SPRING PACK NYLON PLATE
FINISH NONE		NEXT ASSY	USED ON		APPROVED: J. BECHTOLD	11/17/05	
		ASSEMBLY APPLICATION		CURRENT TIME/DATE/FILE LOCATION:		DRAWING NUMBER: 16067	
				DRAWING ARCHIVE LOCATION: http://dovinci.as.arizona.edu/ccad/default.html		REVISION: A	