

REVISIONS			
LTR	DESCRIPTION	DATE	REVIEWED BY / APPROVED
A	INITIAL RELEASE	03/28/04	J. BROWN / S. LANDIS

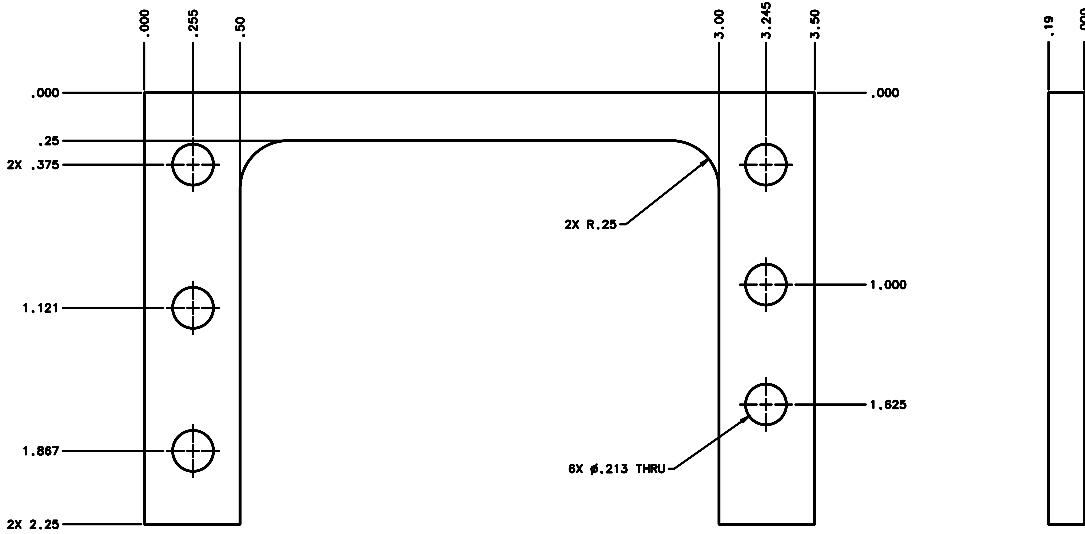

SCALE 4:1

NOTES:

- BREAK SHARP EDGES & DEBURR.
- MACHINED SURFACE FINISH TO BE 125 RMS OR BETTER.
- ANODIZE PER MIL-A-8625, TYPE II, CLASS 2 - BLACK.
- ALL DIMENSIONS APPLICABLE BEFORE ANODIZING.

DO NOT SCALE DRAWING		THIS DRAWING CREATED IN:		Steward Observatory, University of Arizona	
TOLERANCES UNLESS OTHERWISE SPECIFIED		ASAP	ASAP	933 N. Cherry Avenue, Tucson, AZ 85721 (520)621-7856	
TOLERANCES IN ACCORDANCE WITH SPC 114, 114-S4		<input type="checkbox"/>	<input type="checkbox"/>	PROJECT: MMT	
UNLESS OTHERWISE SPECIFIED		DESIGNED BY:	DATE:	PROJECT: MAESTRO	
LINES: REGULAR		DRAWN BY:	DATE:	TITLE: INJECTION OPTICS MOUNTING BOX SHIM	
DIMENSIONS: .001" - .010" .01" - .050" .050" - .100" .100" - .500" .500" - 1.000" 1.000" - 2.000" 2.000" - 5.000" 5.000" - 10.000" 10.000" - 25.000" 25.000" - 50.000" 50.000" - 100.000" 100.000" - 250.000" 250.000" - 500.000" 500.000" - 1000.000"		APPROVED BY:	DATE:	DRAWN BY: D	
DIMENSIONS: .001" - .010" .01" - .050" .050" - .100" .100" - .500" .500" - 1.000" 1.000" - 2.000" 2.000" - 5.000" 5.000" - 10.000" 10.000" - 25.000" 25.000" - 50.000" 50.000" - 100.000" 100.000" - 250.000" 250.000" - 500.000" 500.000" - 1000.000"		APPROVED BY:	DATE:	DRAWN BY: D	
MATERIAL		14266	MMT-MAESTRO	PART OR BOX: 14266	
AL ALLOY 6061-T6		NEXT ASSY	USED ON	REVISION: A	
FINISH		ASSEMBLY APPLICATION		SHEET 1 OF 1	