

REVISIONS				
LTR	DESCRIPTION	DATE	REVISED BY	APPROVED
A	INITIAL RELEASE	03/29/05	J. BRENNAN	G. LANDIS
B	ADDED FLAT PATTERNS & HEAT TREAT NOTE; REARRANGED & REDIMENSIONED SOME VIEWS; NO DESIGN CHANGES	6/31/05	J. BRENNAN/ R. NAGY	R. WARNER

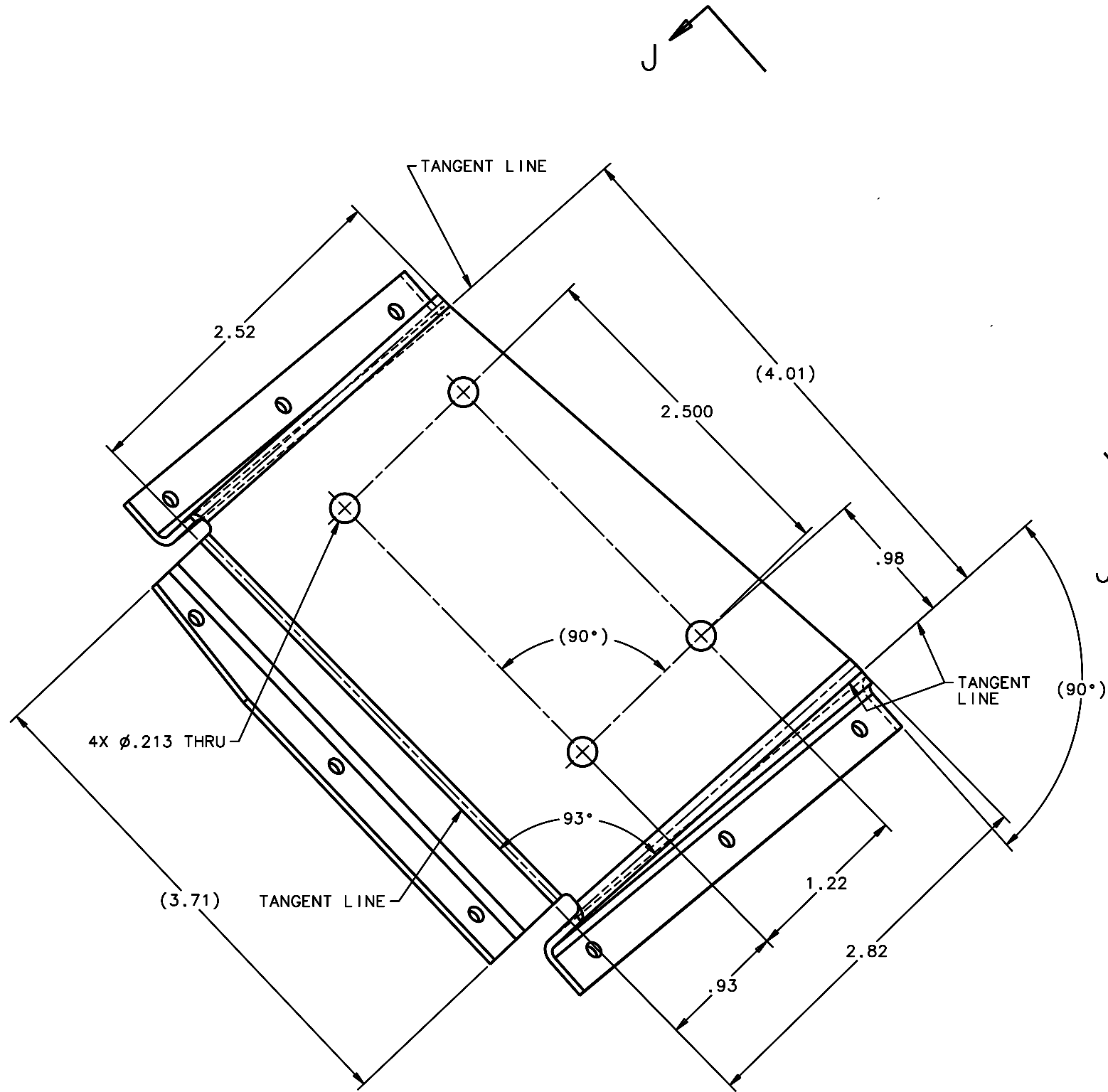

VIEW F-F SHT 6

SCALE 2:1

THIS SHT
(J-J PERPENDICULAR
TO TANGENT LINE)

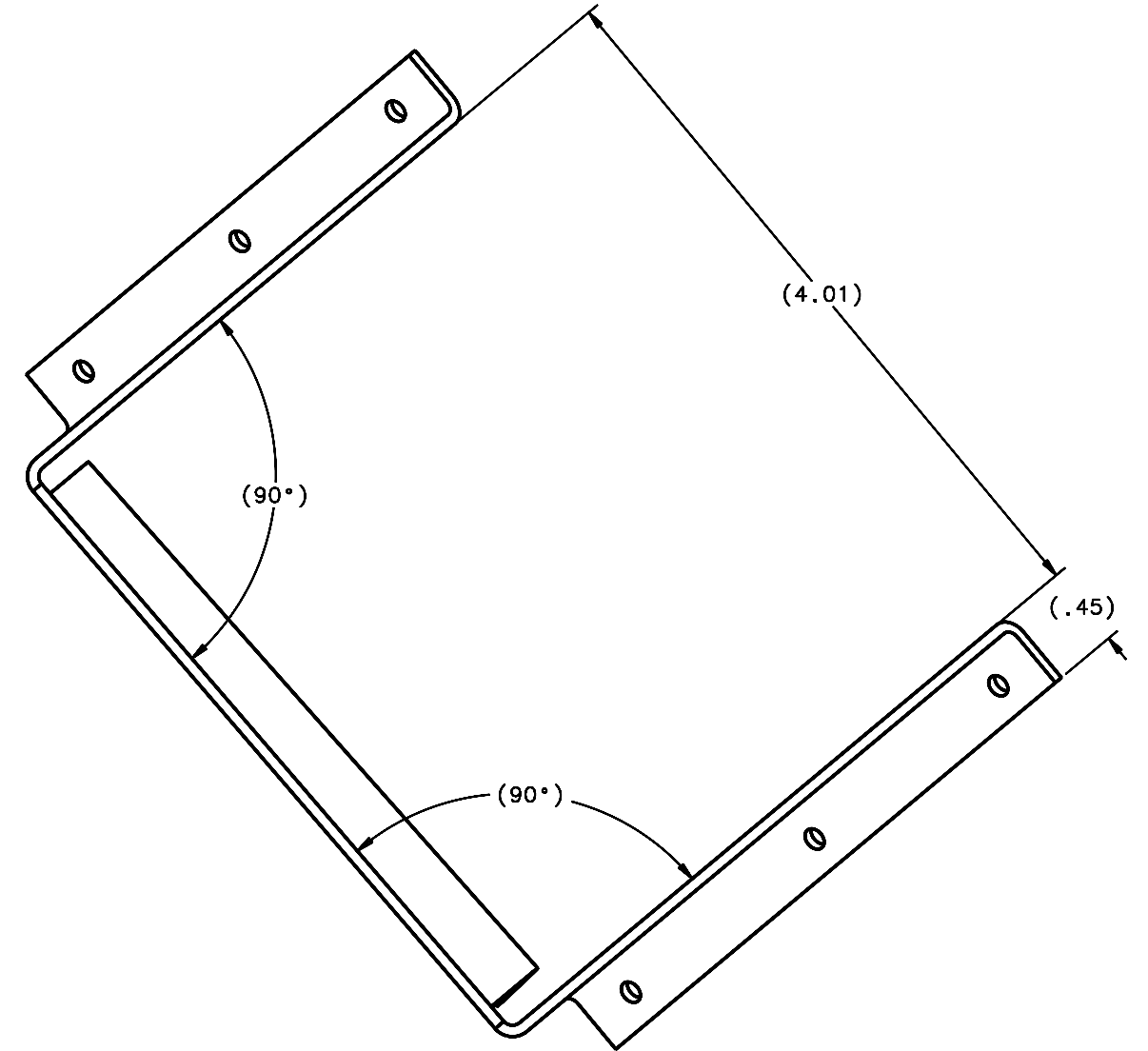

VIEW J-J THIS SHT

SCALE 2:1

DO NOT SCALE DRAWING INTERPRET DIMENSIONS AND TOLERANCES IN ACCORDANCE WITH ASME Y14.5M-94		THIS DRAWING CREATED IN: ACAD <input type="checkbox"/> MECH <input type="checkbox"/> IDEAS <input checked="" type="checkbox"/>		Steward Observatory, University of Arizona 933 N. Cherry Avenue, Tucson, AZ 85721 (520)621-7659	
TOLERANCES UNLESS OTHERWISE SPECIFIED LINEAR ANGLAR .X = NA .XX = ±.03 ± 1° .XXX = ±.010 DIAMETRICAL SEE SPEC S-002		DESIGNED BY: D. DEAN	DATE: 09/23/04	CATEGORY: MMT	
MATERIAL INVAR 36 ALLOY, 16 B.G. (.0625)		DRAWN BY: R. ABALDO	09/23/04	PROJECT: MAESTRO	
FINISH 3		CHECKED BY: G. LANDIS	09/23/04	TITLE: GUIDE CAMERA MOUNTING BOX	
ASSEMBLY APPLICATION		APPROVED: M. REED	09/23/04	DRAWING NUMBER: 14270	
		APPROVED:		PLOT SIZE SCALE: D -	REVISION: B
		APPROVED:		DRAWING NUMBER: 14270	REVISION: B
		CURRENT TIME/DATE/FILE LOCATION:		SHEET 7 OF 8	
		DRAWING ARCHIVE LOCATION: http://dovinci.as.arizona.edu/ccod/default.html			