

SCALE 2:1

REVISIONS			
LTR	DESCRIPTION	DATE	REVISED BY / APPROVED
A	INITIAL RELEASE	03/28/04	J. BROWN / S. LANDIS

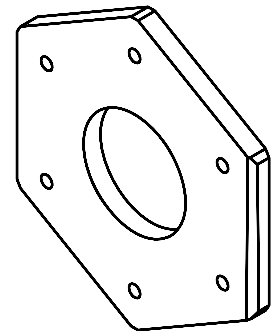

NOTES:

- BREAK SHARP EDGES & DEBURR.
- MACHINED SURFACE FINISH TO BE 125 RMS OR BETTER.
- ANODIZE PER MIL-A-8625, TYPE II, CLASS 2 - BLACK.
- ALL DIMENSIONS APPLICABLE BEFORE ANODIZING.

DO NOT SCALE DRAWING		THIS DRAWING CREATED IN:		Steward Observatory, University of Arizona	
TOLERANCES UNLESS OTHERWISE SPECIFIED		ASAP	ASAP	933 N. Cherry Avenue, Tucson, AZ 85721 (520)621-7856	
TOLERANCES IN ACCORDANCE WITH SPC 114, 114-04		<input type="checkbox"/>	<input type="checkbox"/>	PROJECT: MMT	
UNLESS OTHERWISE SPECIFIED		DESIGNED BY:	DATE:	PROJECT: MAESTRO	
LINES: REGULAR		D. DEAN	06/21/04	TITLE: GUIDE CAMERA ISOLATION PLATE	
DIMENSIONS: .001		DESIGNED BY:	DATE:		
FRACTIONAL: .001		G. LANDIS	06/21/04		
DECIMALS: .001		APPROVED BY:	DATE:		
MATERIAL:		M. REED	06/21/04		
AL ALLOY 6061-T6		APPROVED:		PLAT TO BE BORED:	NUMBER BORED:
FINISH: 3		14174	MMT-MAESTRO	D -	14171
NEXT ASSY USED ON:		APPROVED:		REVISION: A	
ASSEMBLY APPLICATION:		COMPARE THIS DRAWING WITH LOCATION:		SHEET 1 OF 1	