

| REVISIONS | | | | |
|-----------|-----------------|---------|------------|-----------|
| LTR | DESCRIPTION | DATE | REVISED BY | APPROVED |
| A | INITIAL RELEASE | 3/22/05 | R. NAGY | G. LANDIS |

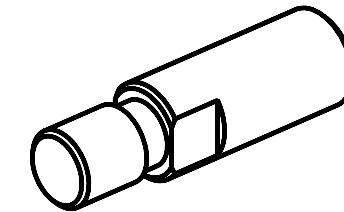
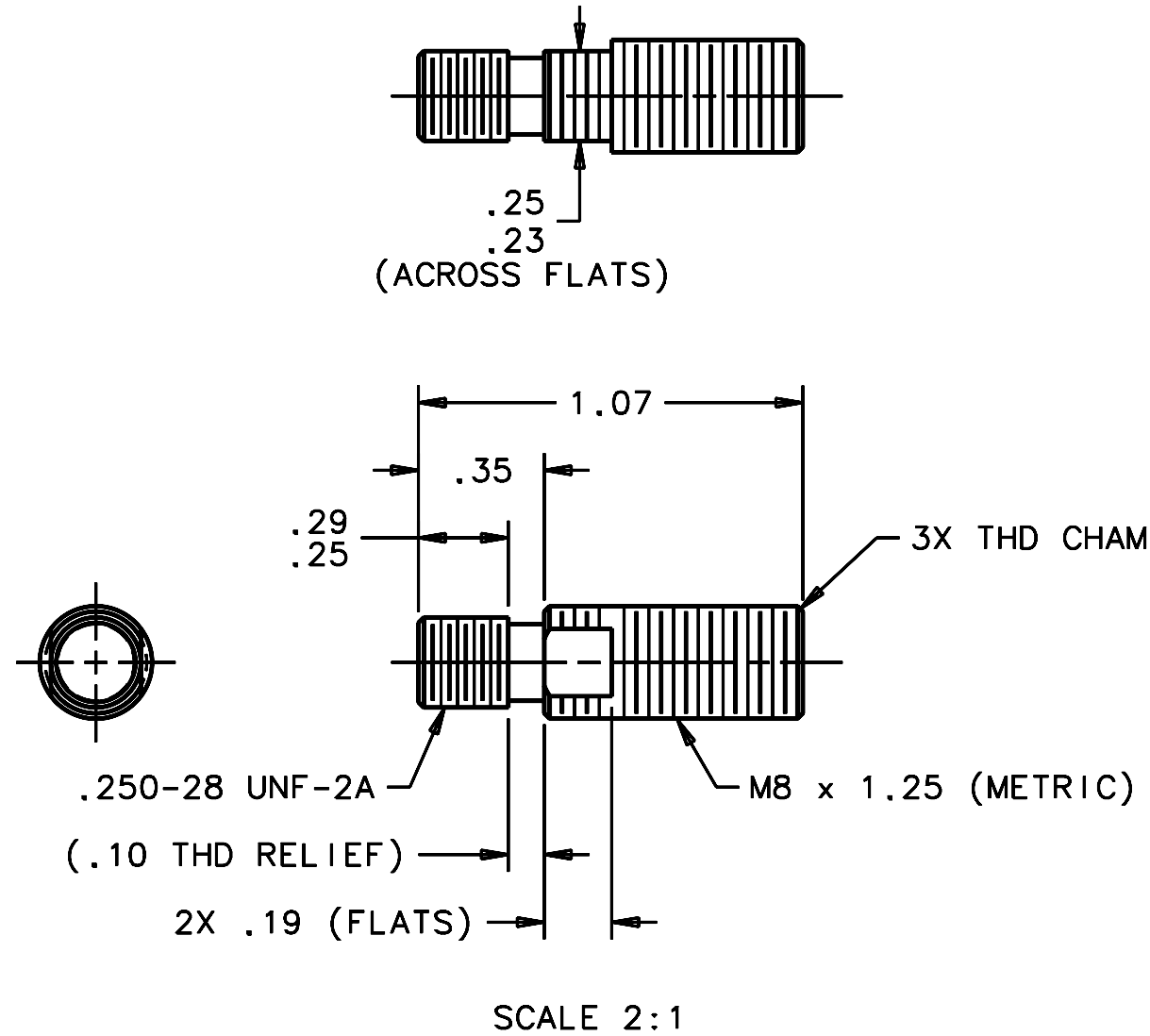

SCALE NTS

NOTES:

1. BREAK SHARP EDGES & DEBURR.
2. MACHINED SURFACE FINISH TO BE 125 RMS OR BETTER.
3. MACHINED FILLETS TO BE R.015 MAX.
4. ZINC CHROMATE PER ASTM-B-633-98, TYPE II, GOLD.
5. DIMENSIONS ARE BEFORE ZINC CHROMATE.
6. (1) REQUIRED PER NEXT ASSEMBLY.

| | | | | | | | |
|---|--|---|--|--|--|---|--|
| DO NOT SCALE DRAWING INTERPRET DIMENSIONS AND TOLERANCES IN ACCORDANCE WITH ASME Y14.5M-94 | | THIS DRAWING CREATED IN: ACAD <input type="checkbox"/> MECH <input type="checkbox"/> IDEAS <input checked="" type="checkbox"/> | | Steward Observatory, University of Arizona 933 N. Cherry Avenue, Tucson, AZ 85721 (520)621-7659 | | | |
| TOLERANCES UNLESS OTHERWISE SPECIFIED LINEAR ANGULAR .X - NA °1 .XX - 2.02 .XXX - NA DIAMETRICAL SEE SPEC S-002 | | DESIGNED BY: R. NAGY | | DATE: 12/1/04 | | CATEGORY: MMT | |
| MATERIAL 1018 STEEL | | DRAWN BY: R. NAGY | | DATE: 12/1/04 | | PROJECT: MAESTRO | |
| FINISH 4 | | CHECKED BY: G. LANDIS | | DATE: 3/21/05 | | TITLE: GRATING CELL & PLATFORM STEPPER MOTOR THREADED ADAPTER-M8x.250-28 | |
| NEXT ASSY USED ON | | APPROVED: M. REED | | DATE: 3/22/05 | | PLOT SIZE SCALE: B - | |
| ASSEMBLY APPLICATION | | APPROVED: J. BECHTOLD | | DATE: 3/22/05 | | DRAWING NUMBER: 14199 | |
| CURRENT TIME/DATE/FILE LOCATION: | | APPROVED: | | DRAWING NUMBER: 14199 | | REVISION: A | |
| DRAWING ARCHIVE LOCATION: http://devinci.es.arizona.edu/ocod/default.html | | SHEET 1 OF 1 | | | | | |