

REVISIONS				
LTR	DESCRIPTION	DATE	REVISED BY	APPROVED
A	INITIAL RELEASE	05/09/05	J. BRENNAN	G. LANDIS

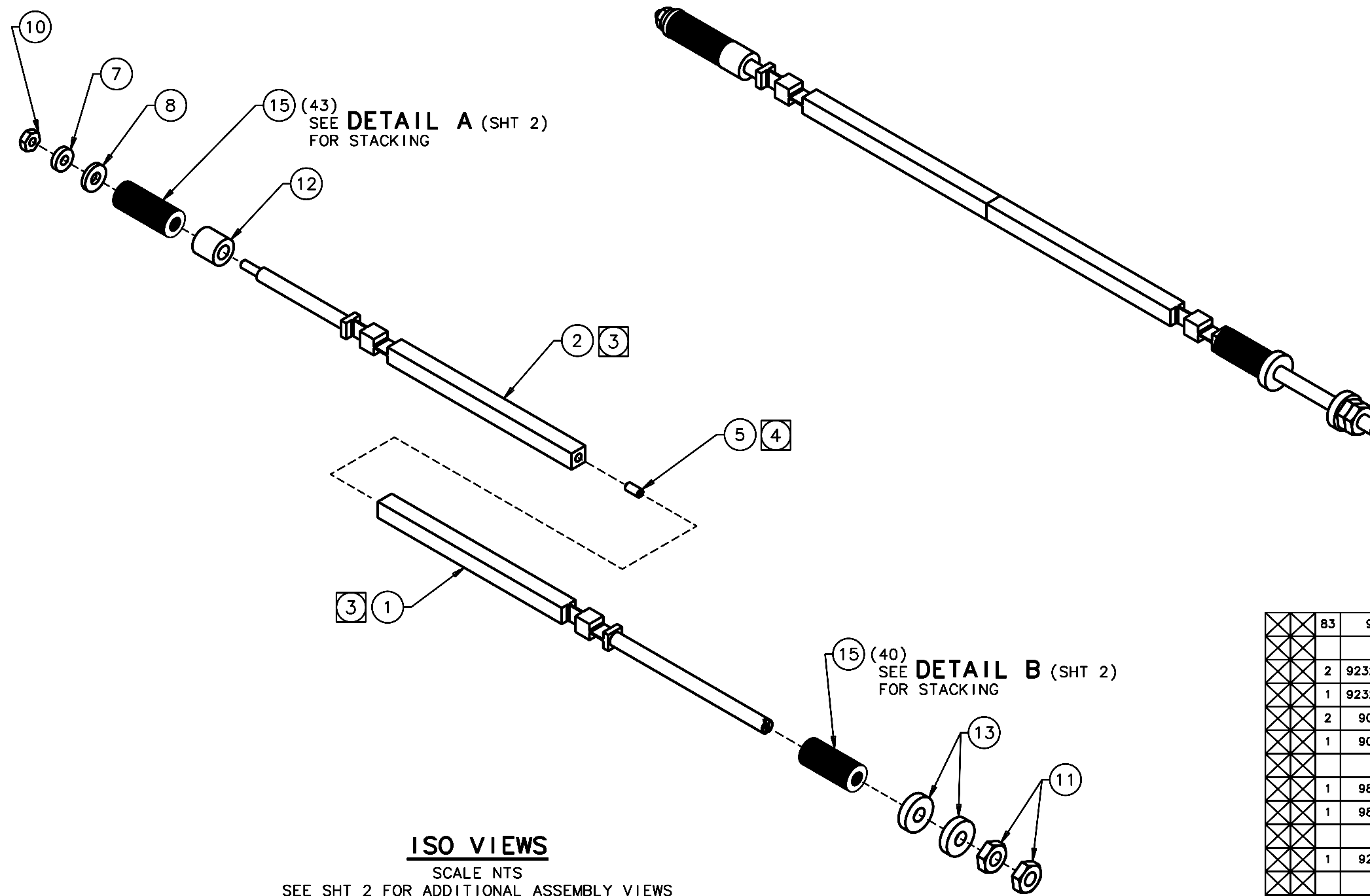

ISO VIEWS

SCALE NTS
SEE SHT 2 FOR ADDITIONAL ASSEMBLY VIEWS

QTY PER ASSY	PART NUMBER	PART DESCRIPTION	MANUFACTURER or MAT'L SPEC	ITEM NO.
	83	9713K59	BELLEVILLE DISC SPRING, .190 ID x .375 OD x .020 THK, SS	15
				14
	2	92320A237, #10	SPACER, ROUND, UNTHREADED, .5 OD x .125 LG, 18-8 SS	13
	1	92320A229, #10	SPACER, ROUND, UNTHREADED, .375 OD x .375 LG, 18-8 SS	12
	2	90480A195	NUT, HEX, MACHINE SCREW, .190-32 UNF x .12 H, STL, Zn-PLT	11
	1	90480A005	NUT, HEX, MACHINE SCREW, .112-40 UNC x .09 H, STL, Zn-PLT	10
				9
	1	98370A025	WASHER, FLAT, FINISHED, #6 x .375 OD x .078 THK, 18-8 SS	8
	1	98370A024	WASHER, FLAT, FINISHED, #4 x .312 OD x .078 THK, 18-8 SS	7
				6
	1	92311A106	SETSCREW, CUP PT, HEX SKT, .112-40 UNC-2A x .250 LG, 18-8 SS	5
				4
				3
	1	13665	LONGITUDINAL LINK "B"	2
	1	13664	LONGITUDINAL LINK "A"	1

NOTES:

1. 1 REQUIRED.
2. DIMENSIONS FOR REF ONLY.
THIS SETUP WILL NEED TO BE DISASSEMBLED & ADJUSTED AS REQD AT ITS NEXT ASSEMBLY.
- 3 TO PREVENT FLEXING OF ITEMS 1 & 2 LINKS, HANDLE, STORE & SHIP IN A RESTRAINED CONDITION.
- 4 APPLY A COMPATIBLE ANTISEIZE COMPOUND, IF REQUIRED.

DO NOT SCALE DRAWING INTERPRET DIMENSIONS AND TOLERANCES IN ACCORDANCE WITH ASME Y14.5M-94		THIS DRAWING CREATED IN: ACAD <input type="checkbox"/> MECH <input type="checkbox"/> IDEAS <input checked="" type="checkbox"/>		Steward Observatory, University of Arizona 933 N. Cherry Avenue, Tucson, AZ 85721 (520)621-7659	
TOLERANCES UNLESS OTHERWISE SPECIFIED LINEAR .1 - NA .05 - NA .02 - NA ANGULAR NA DIAMETRICAL SEE SPEC S-002		DESIGNED BY: S. MATHEWS	DATE: 8/27/04	CATEGORY: MMT	
MATERIAL - NEXT ASSY USED ON		DRAWN BY: R. NAGY	10/26/04	PROJECT: MAESTRO	
FINISH -		CHECKED BY: G. LANDIS	03/21/05	TITLE: GRATING LONGITUDINAL SUPPORT LINK ASSEMBLY	
ASSEMBLY APPLICATION		APPROVED BY: M. REED	05/09/05	DRAWING NUMBER: 13662	
CURRENT TIME/DATE/FILE LOCATION:		APPROVED BY: J. BECHTOLD	05/09/05	REVISION: A	
DRAWING ARCHIVE LOCATION: http://dovinci.as.arizona.edu/ocad/default.html		APPROVED BY: R. WARNER	05/09/05	PLOT SIZE SCALE: D -	