

REVISIONS				
LTR	DESCRIPTION	DATE	REVISED BY	APPROVED
A	INITIAL RELEASE	04/26/05	J. BRENNAN	G. LANDIS

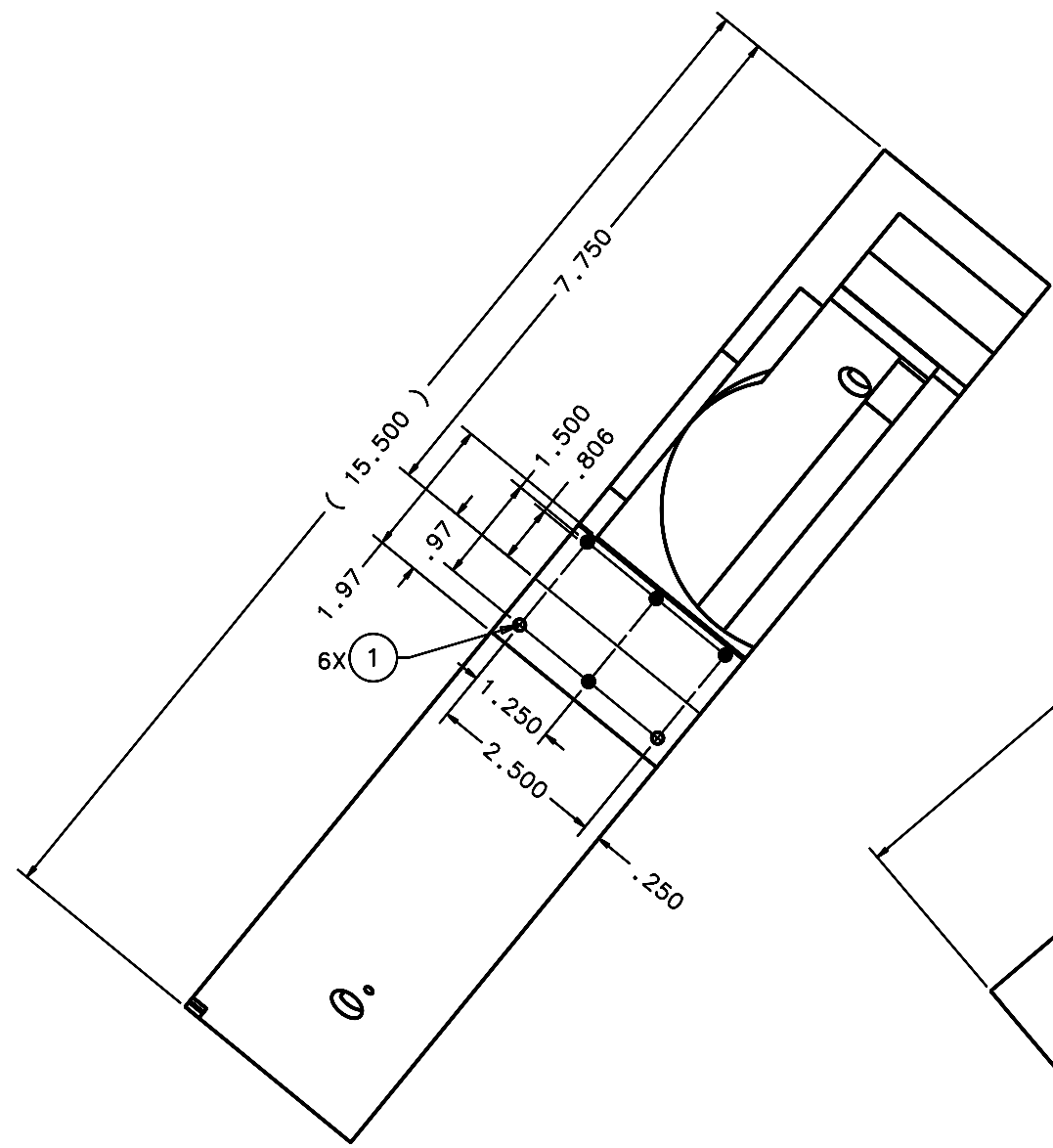

VIEW C-C
SHT 2
SCALE .75:1
39.3°

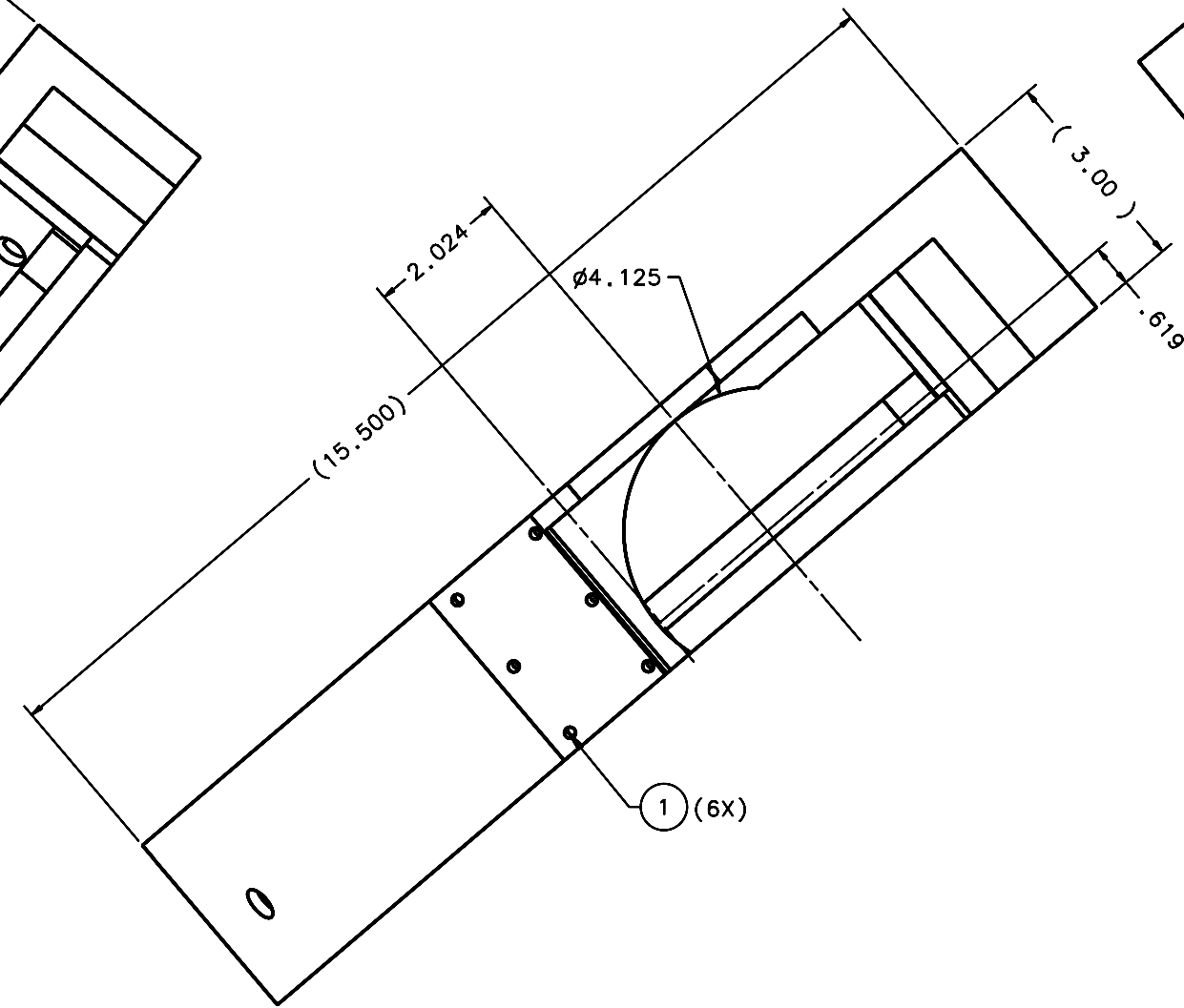

VIEW D-D
SHT 2
SCALE .75:1
42.6°

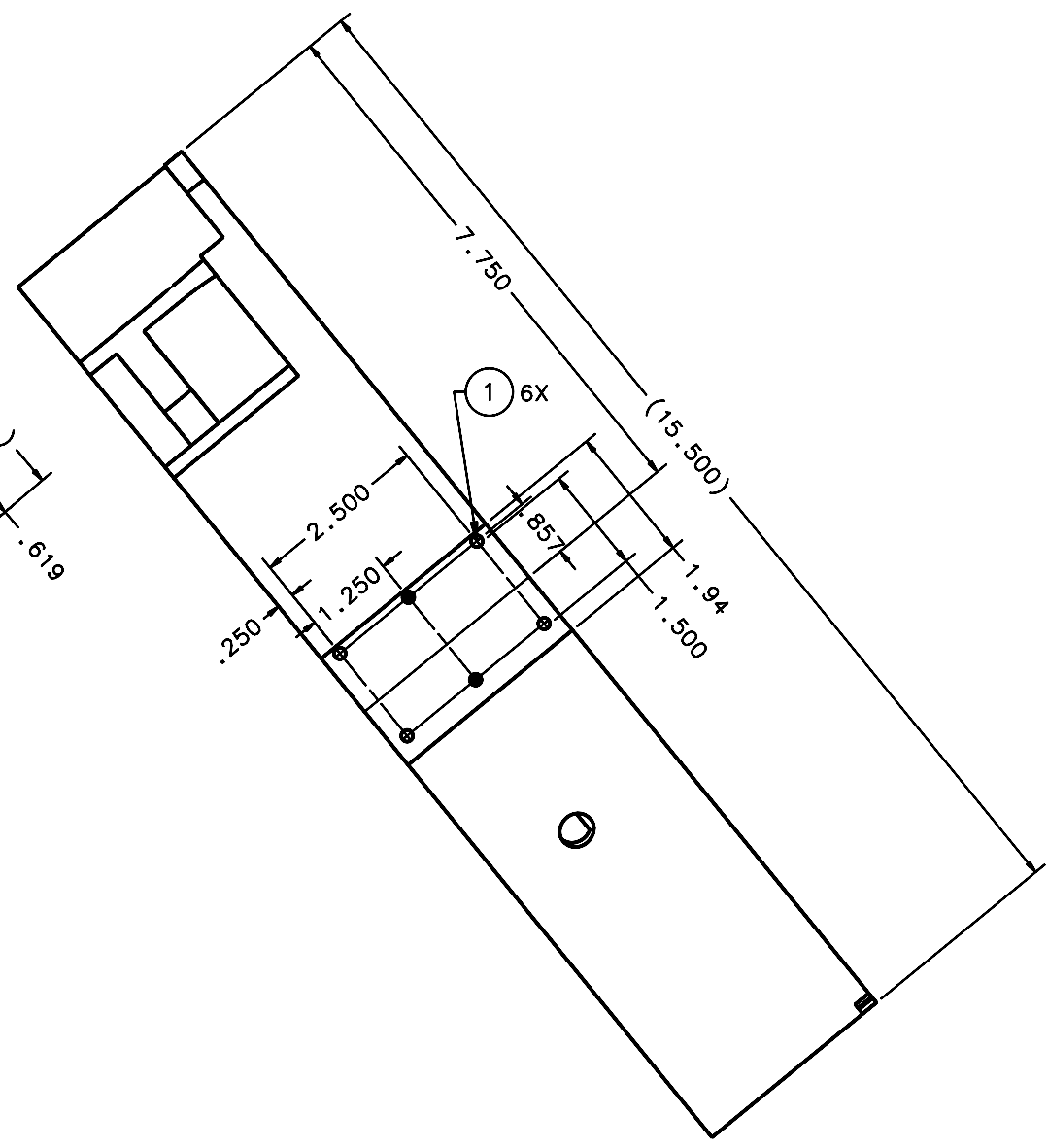

VIEW E-E
SHT 2
SCALE .75:1
39.3°

DO NOT SCALE DRAWING INTERPRET DIMENSIONS AND TOLERANCES IN ACCORDANCE WITH ASME Y14.5M-94		THIS DRAWING CREATED IN: ACAD <input type="checkbox"/> MECH <input type="checkbox"/> IDEAS <input checked="" type="checkbox"/>		Steward Observatory, University of Arizona 933 N. Cherry Avenue, Tucson, AZ 85721 (520)621-7659	
TOLERANCES UNLESS OTHERWISE SPECIFIED LINEAR .X = ±.03 .XX = ±.015 .XXX = ± ANGULAR ±°		DESIGNED BY: D. DEAN DATE: 4/06/04		CATEGORY: MMT	
DIAMETRICAL SEE SPEC S-002		DRAWN BY: D. DEAN 12/03/04		PROJECT: MAESTRO	
MATERIAL AL ALLOY 6061-T6		CHECKED BY: G. LANDIS 03/21/05		TITLE: DEWAR MOUNTING RING	
FINISH		APPROVED: J. BECHTOLD 04/26/05		APPROVED: R. WARNER 04/26/05	
ASSEMBLY APPLICATION		APPROVED:		PLOT SIZE SCALE: D -	
		APPROVED:		DRAWING NUMBER: 13448	
		CURRENT TIME/DATE/FILE LOCATION:		REVISION: A	
		DRAWING ARCHIVE LOCATION: http://dovinc1.as.arizona.edu/oced/dofault.html		SHEET 4 OF 7	