

REVISIONS				
LTR	DESCRIPTION	DATE	REVISED BY	APPROVED
A	INITIAL RELEASE	04/26/05	J. BRENNAN	G. LANDIS

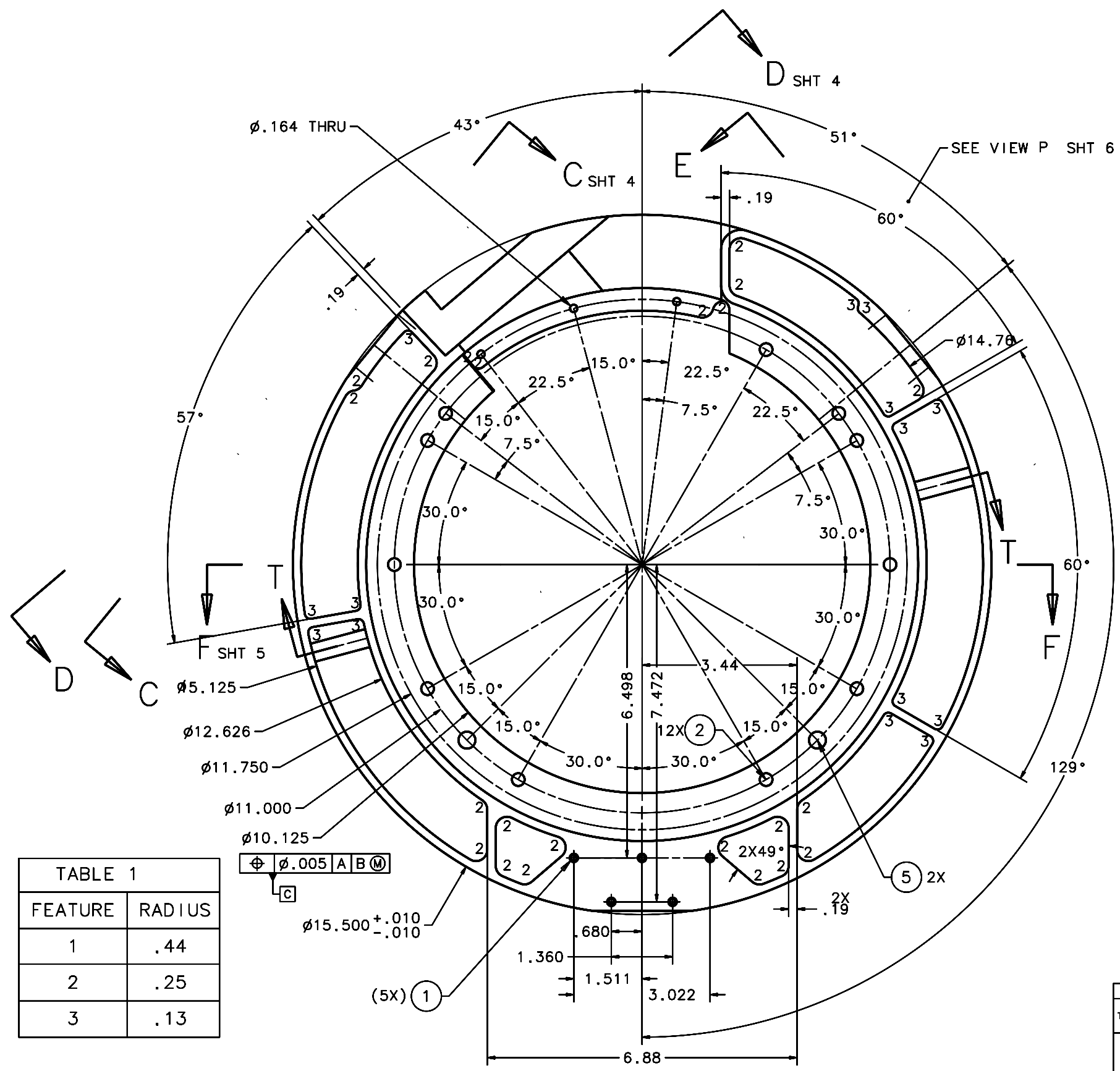

FEATURE	RADIUS
1	.44
2	.25
3	.13

GRATING SIDE OF RING
SCALE .75:1

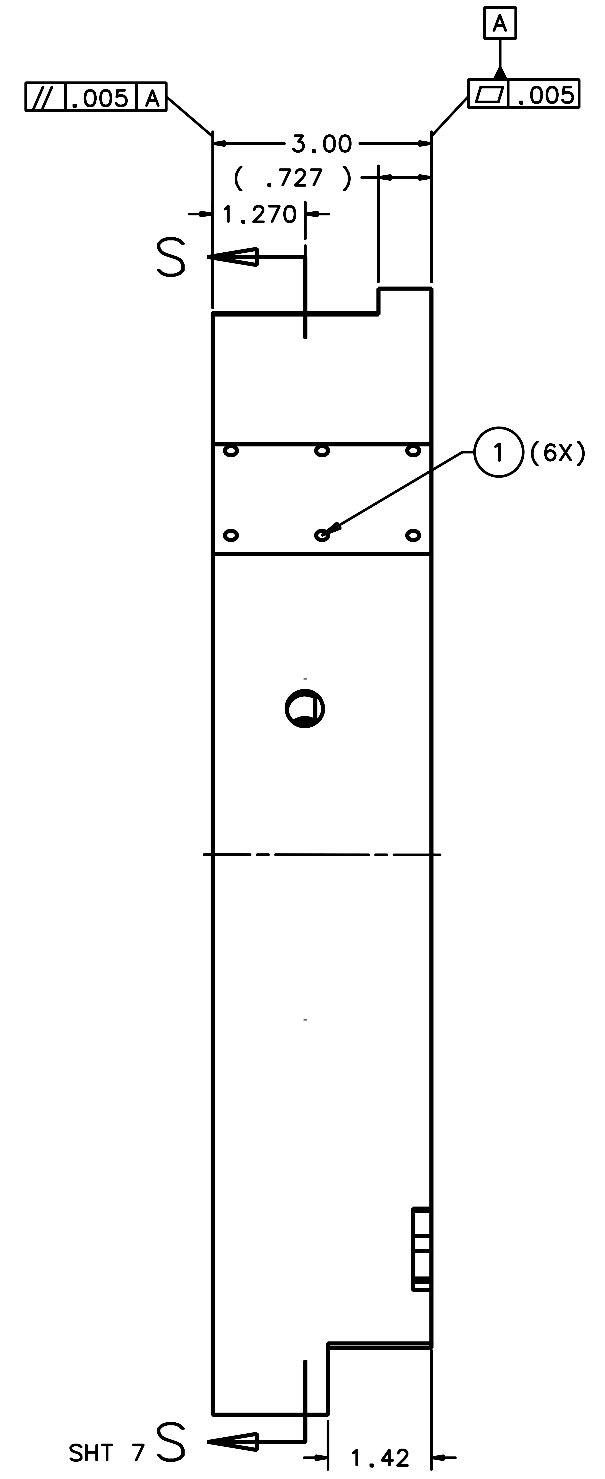

DO NOT SCALE DRAWING		THIS DRAWING CREATED IN:		Steward Observatory, University of Arizona	
INTERPRET DIMENSIONS AND TOLERANCES IN ACCORDANCE WITH ASME Y14.5M-94		ACAD	MECH	IDEAS	933 N. Cherry Avenue, Tucson, AZ 85721 (520)621-7659
TOLERANCES UNLESS OTHERWISE SPECIFIED		<input type="checkbox"/>	<input type="checkbox"/>	<input checked="" type="checkbox"/>	DESIGNED BY: D. DEAN DATE: 4/06/04 CATEGORY: MMT
LINEAR .X = ±.03 .XX = ±.015 .XXX = ±				DRAWN BY: D. DEAN 12/03/04 PROJECT: MAESTRO	
ANGULAR ± °				CHECKED BY: G. LANDIS 03/21/05 TITLE: DEWAR MOUNTING RING	
DIAMETRICAL SEE SPEC S-002				APPROVED: J. BECHTOLD 04/26/05	
DIMENSIONS ARE IN INCHES / DIMENSIONS IN 1.1 ARE METRIC				APPROVED: R. WARNER 04/26/05	
MATERIAL AL ALLOY 6061-T6	14476	MMT-MAESTRO	APPROVED:	PLOT SIZE SCALE: D -	DRAWING NUMBER: 13448
FINISH	NEXT ASSY	USED ON	APPROVED:		REVISION: A
ASSEMBLY APPLICATION				CURRENT TIME/DATE/FILE LOCATION: DRAWING ARCHIVE LOCATION: http://dovinc1.as.arizona.edu/ocad/dfault1.html	