

**NEW**

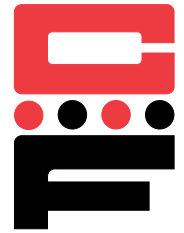

# Low-Profile Panel Fastener

## Series LPH



LPH panel fasteners are preassembled for attachment to removable sheet metal panels. Screw assemblies remain captive for servicing ease and provide low profile when secure. Slotted head with deep skirt allows tool or finger operation.

Series	Material	Finish*
LPH	Carbon Steel	Bright Nickel over Copper Flash

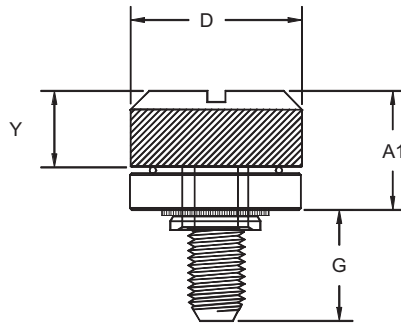
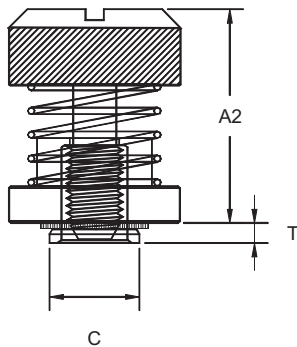

\*Black Nitride (BN) finish available  
 Thread: Class 2A (6g ISO Metric)  
 Use in: Materials with Rockwell Hardness of B-60 or less.

Part Number Structure:  
 LPH- 0- 440- 30



### Dimensions & Specifications

	Thread Size	Type	Thread Code	Screw Length Code	Min. Sheet Thickness	T Max.	G ±.015 in.	C Max.	D ±.010 in.	Y ±.005 in.	A1 Max.	A2 Nom.	+0.003 in. - .000	Min.
INCH (in.)	#4-40	LPH-0 LPH-1 LPH-2	440	30	.030 .040 .060	.030 .038 .058	.300	.202	.406	.202	.325	.595	.203	.26
	#6-32	LPH-0 LPH-1 LPH-2	632	30	.030 .040 .060	.030 .038 .058	.300	.218	.438	.202	.325	.595	.219	.28
	#8-32	LPH-0 LPH-1 LPH-2	832	30	.030 .040 .060	.030 .038 .058	.300	.249	.468	.207	.330	.600	.250	.29
	#10-32	LPH-0 LPH-1 LPH-2	1032	30	.030 .040 .060	.030 .038 .058	.300	.311	.530	.220	.335	.605	.312	.33
	1/4-20	LPH-2	420	35	.060	.058	.350	.374	.625	.242	.385	.675	.375	.38
METRIC (mm)	M3X0.5	LPH-1 LPH-2	M3	30	1 1.5	0.97 1.48	7.62	5.48	10.31	5.13	8.26	15.11	5.5	6.6
	M4x0.7	LPH-1 LPH-2	M4	30	1 1.5	0.97 1.48	7.62	6.38	11.89	5.26	8.38	15.24	6.4	7.37
	M5x0.8	LPH-1 LPH-2	M5	30	1 1.5	0.97 1.48	7.62	7.98	13.46	5.59	8.51	15.37	8	8.38
	M6x1	LPH-1 LPH-2	M6	35	1.5	1.48	8.89	9.48	15.88	6.12	9.78	17.15	9.5	9.65





# Low-Profile Panel Fastener

## Series LPH

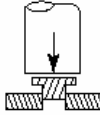
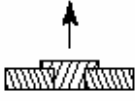

### Installation & Performance Data

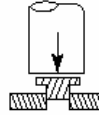
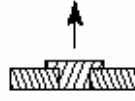
Type	5052-H34 Aluminum					
	 Thread Code	 Installation Force (lbs.)	 Pushout (lbs.)	 Thread Code	 Installation Force (kN)	 Pushout (N)
LPH-0 LPH-1 LPH-2	440	2200	60-180	M3	9.5	280-820
	632	2400	64-185	n/a	n/a	n/a
	832	2800	66-195	M4	12	300-885
	1032	3500	70-185	M5	15	315-1150
	420	4300	319	M6	19	1420

Note: May be used in Cold-Rolled Steel with a hardness of B60 or less.